

P.P. NO. 10-00-005-102-010, 115 10-00-050-000-001	
SPLIT # 11476	DATE OF SURVEY
MAP PAGE 10-00-005-0	
SURVEYOR	

CATHERINE M. SPAETH
50.87 ACRES
0-00-005-102-008

11470
11-A
MERRILL A. NASH
33.00 ACRES
11-00-091-000-002
11-00-091-000-001

BROKERS FEDERAL
MORTGAGE CORPORATION

8.78 AC.

10-00-005-102-066

AREA OF ANNEXATION 2.30 ACRES

57 SOUTHWEST

PROPOSED ANNEXATION
OF
2.30 ACRES OF LAND
IN
ORIGINAL EATON TOWNSHIP T91
TO THE
CITY OF ELYRIA
COUNTY OF LORAIN STATE OHIO

PARCEL OWNED BY:

VOLNEY O. & RUTH C. NASH
AS RECORDED IN D.V. 301, PG. 468,
LORAIN COUNTY RECORD OF DEEDS.

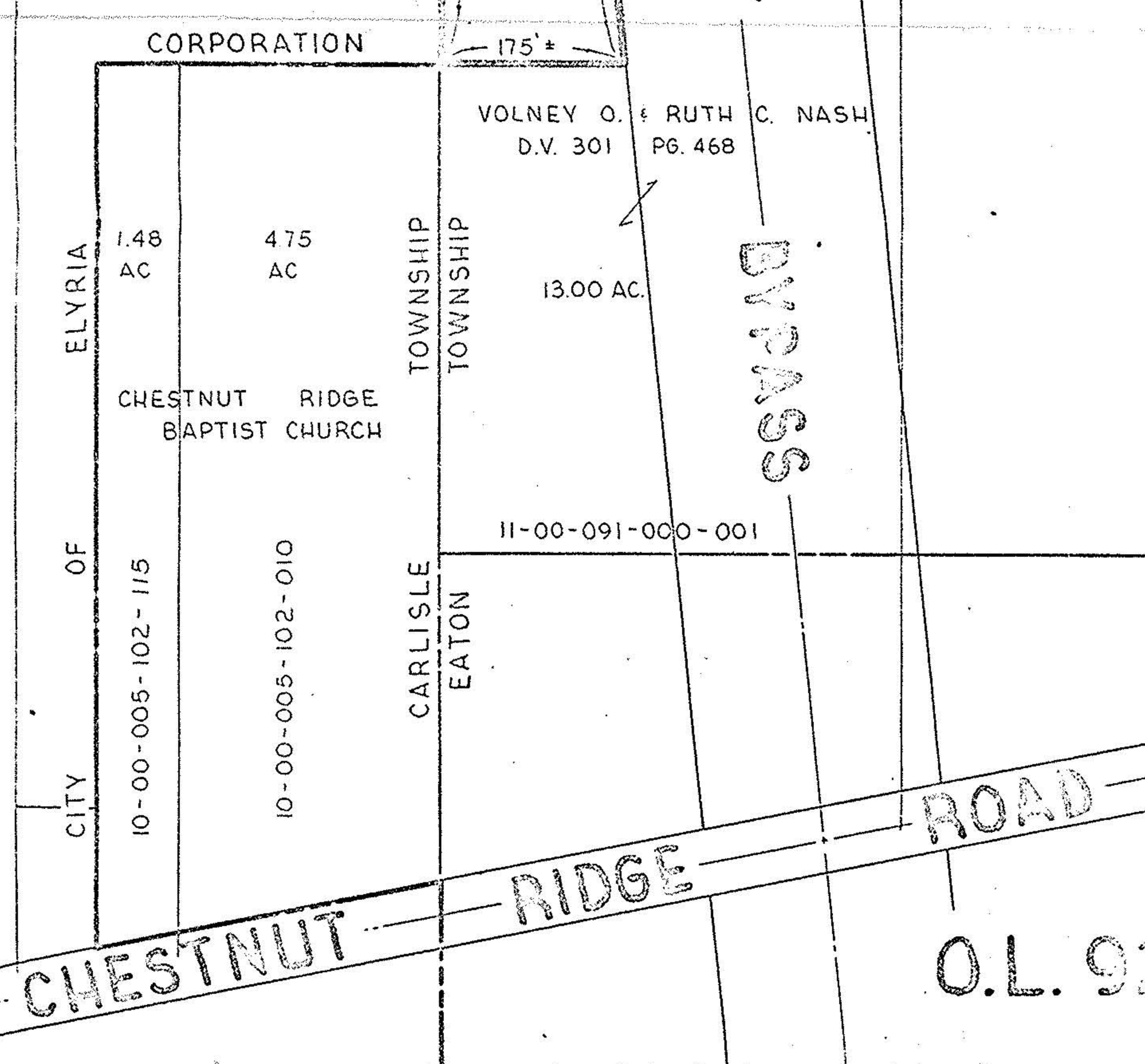

O.L. 91

O.L. 92