

P.P. NO. 16-00-016-101-022	
SPLIT # 20304	DATE OF SURVEY
MAP PAGE 10-F	
SURVEYOR RODGER G. SIMON	

TOTAL ORIGINAL ACREAGE	177.6156 Ac.
- PCL. No 1	40.1676 Ac.
2-14-91 RMOR.	137.4480 Ac.
- PCL. No 2	35.5881 Ac.
1-29-92 RMOR.	101.8593 Ac.
- PCL. No 3	32.8579 Ac.
1-07-93 RMOR.	69.0019 Ac.

DENOTES MON. BOX W/ IRON PIN FOUND  
 SET BY CO. ENGRS. DEPT. - USED  
 DENOTES IRON PIN FOUND or SET

SURVEY FOR  
**RICHARD J. & MARGARET M. BURRER**  
 PART OF ORIG. SECTIONS 12, 13 & 19 OF CARLISLE TWP.  
 COUNTY OF LORAIN STATE OF OHIO  
 SCALE 1"=200 JAN. 1991  
 LAUNDON • SIMON • CAHL & ASSOC.  
 ENGINEERS SURVEYORS  
 106 MIDDLE AVE. ELYRIA, OHIO 44035  
 JOB NO 90-1987

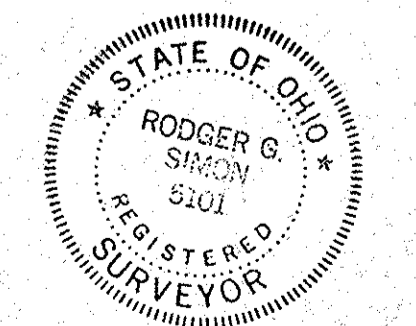

20304
APPROVED LORAIN CO. MAP DEPT.
DATE
PAGE
BY
VOID ANDER

REV. 1-07-93 PCL. 3 R.G.S.  
 REV. 1-20-92 PCL. 2 R.G.S.  
 REV. 2-14-91 PCL. 1 R.G.S.