

Lot 10
Sec. 10

10

#12857

10-00-010
10-A

10-00-010-000
5-50-27' E

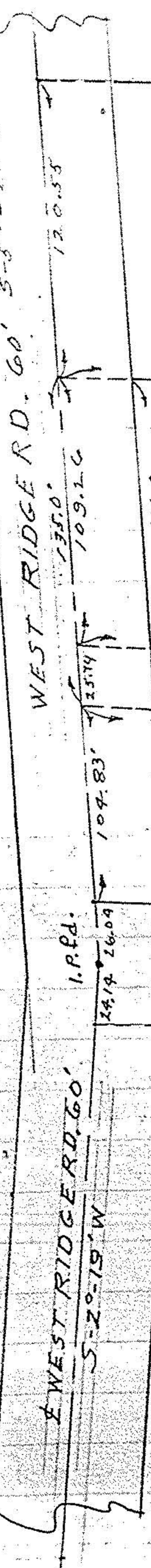

Sec. 10
Sec. 11

#12857

APPROVED	
LORAIN CO.	
MAP DEPT.	
DATE	7-5-79
PAGE	10-A
BY	T. McNeil
VOID AFTER	

SURVEY FOR WILLIAM AND LOIS STEGMAN
 Carlisle Twp. Lorain County, Ohio
 Part of Section 10, 50 Acre 1"=60'
 June 14, 1979
 A.D. Jean 0010, Reg. Surveyor

-054

172.47'

167.67'

392.06'

S-0-00-30'' W, 134.38'