

QUARRY ROAD 60' 385.70' 197.30' N 6° 53' 00" E

417.42'

20' EASEMENT FOR INGRESS & EGRESS

EXISTING 8' SLAG DRIVE

615.0' QUARRY RD.

N. 89° 31' 20" E. 636.32'

PCL. 1
2.9123 Acres

PCL. 2
1.1469 Acres

#17959

-650

-048

1 P. 5et Prock's 602-552
6.88° 26' 00" W. 220.00'

6.88° 26' 00" W. 418.00'

N. 6° 53' 00" E. 15.00'

O.L. 2
O.L. 12

WILLIAM M. JR. & ANNA L. RADO
V. 1063 P. 445 V. 1113 P. 648

N. 6° 53' 00" E. 200.08'
285.08'
85.00'

0.89 Ac. ±

0.26 Ac. ±

1 P. 5et Simask Ave. 320
367-568

3.80 Ac. ± O.L. 2
0.26 Ac. ± O.L. 12

CHARLES J. BUKOVEC
V. 975 P. 897

09-00-002-000
-012-000

#17959

APPROVED
LORAIN CO.
MAP DEPT.

DATE 5-25-88
PAGE 9-00-002-012

BY C. FRANCIS
VOID AFTER 17959

SURVEY OF
PART OF ORIG. LOTS 2 & 12 IN RUSSIA TOWNSHIP

COUNTY OF LORAIN

STATE OF OHIO

MARCH 1988

SCALE 1"=50'

LAUNDON • SIMON • CAHL & ASSOC.
ENGINEERS SURVEYORS

Job No 88-1694

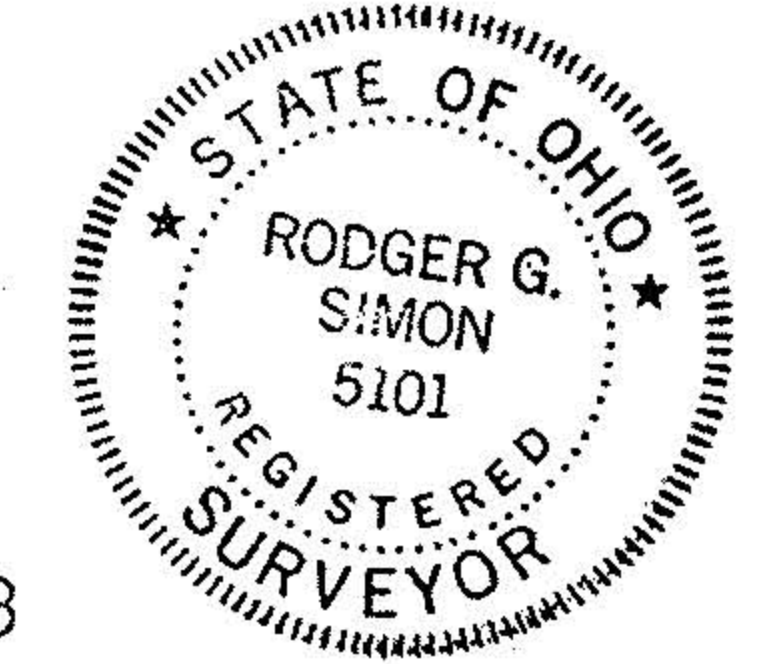

MAR 28 1988