

053-0000-15-00-19296

VOID

CLAY B. & KAREN S. DILL
O.R. VOL. 174, PG. 732

N 00° 08' 20" E

PARCEL "A" 7.8609 AC.

DENNIS & JAYNE WALTER
D.V. 1231, PG. 444

S 89° 55' 01.8" W

390.95' MEAS.

250.00'

1. P. SET

1. P. SET

1. P. SET

1. P. SET

1. P. SET

1. P. SET

1. P. SET

1. P. SET

1. P. SET

1. P. SET

1. P. SET

1. P. SET

1. P. SET

1. P. SET

1. P. SET

1. P. SET

1. P. SET

1. P. SET

1. P. SET

1. P. SET

1. P. SET

1. P. SET

1. P. SET

1. P. SET

1. P. SET

1. P. SET

PARCEL "B" -036

12.4148 AC.

12.4403 AC.

S 00° 22' 55" W 1369.70'

S 00° 27' 21" W 1370.23'

VINCENT J. & ROSE MAHL D.V. 1401, PG. 131

-034

1369.70' REC.

1. P. SET

1. P. SET

1. P. SET

1. P. SET

1. P. SET

1. P. SET

1. P. SET

1. P. SET

WAKEMAN-BELDEN ROAD (S.R. 303) - 60'

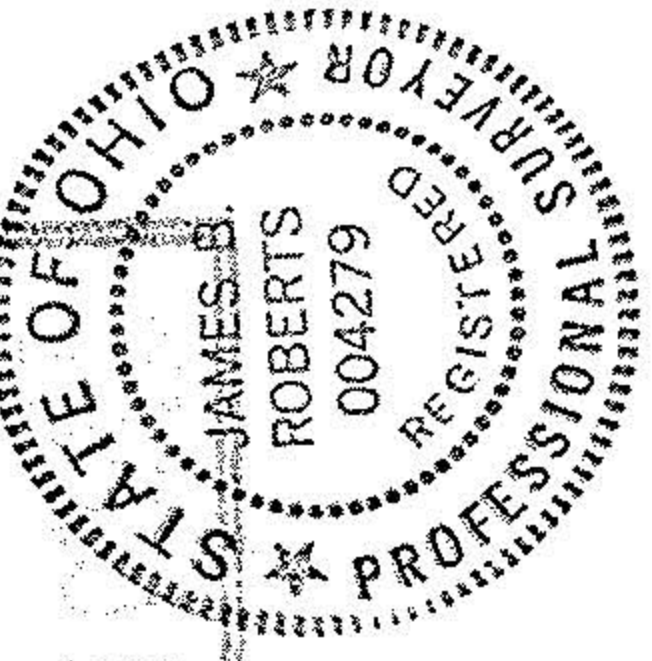

# 19296	
APPROVED	
LORAIN CO.	
MAP DEPT.	
DATE	2-28-91
PAGE	15-H
BY	CAROLYN FRANCIS
VOID AFTER	# 19296

REF: R.P. No. 15-00-053-000-033

MAP of PROPOSED PARCEL SPLIT

PREPARED FOR LORETTA DAWSON

PART of ORIGINAL LAGRANGE TWP. LOT No. 53

TOWNSHIP of LAGRANGE, LORAIN COUNTY, OHIO

K.E. MCCARTNEY & ASSOCIATES
ENGINEERS - SURVEYORS
230 THIRD ST. ELYRIA OHIO
NOVEMBER, 1990 #903366

NORTH

SCALE: 1" = 200'

