

19750

Myrle T. Denham

28.725 Acres Remainder  
Myrle T. Denham by Auditor

0.491

LaGrange Twp  
Existing fence line  
Penfield Twp

0.42

Myrle T. Denham

115.275 Ac remainder  
by Auditor

Total 5,000 Acres

3,125 Ac

429.85'  
S 89° 05' 30" W

N 0° 54' 30" W  
158.00'

263.53'

S 89° 05' 30" W

448.00' E

521.53'

N 89° 05' 30" E  
(1,127.5 Ac)

RRS set  
130.1  
117.11

POT  
1057.91'

34.87'

N 29° 44' 30" E  
337.10'

26.9'

Myrle T. Denham



19750

APPROVED
LORAIN COUNTY MAP DEPT.
DATE 1-24-92
PAGE 15-H 19-D
BY CAROLYN FRANCIS
VOID AFTER # 19750

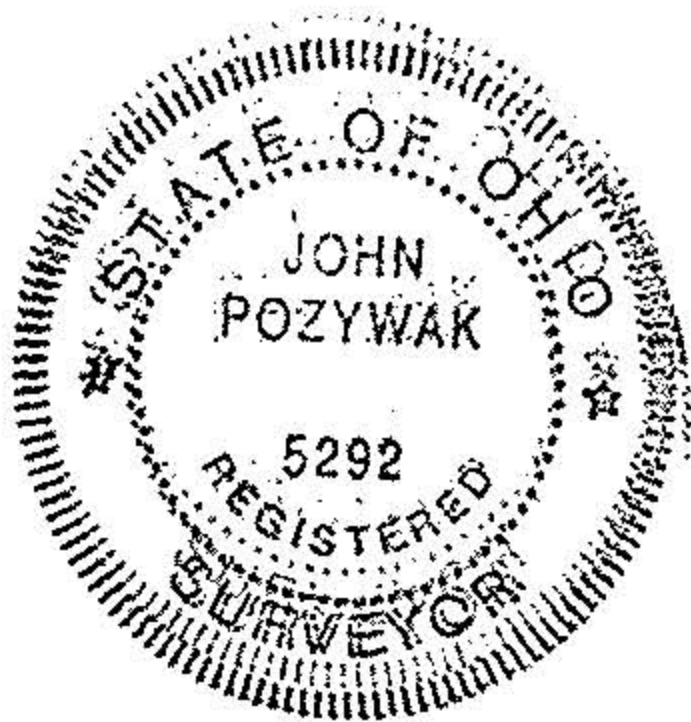

- iron pipes set
- Monument boxes

John Pozrywak  
Reg Surveyor  
5292

Survey for Virgil Smith  
Part original Lot 91 LaGrange Twp  
original Lot 42, Tract 6 Penfield  
Lorain County Ohio  
Scale 1" = 200' Dec 28, 1991