

13.7344 AC. TOTAL

JOHN JOHN CO. D.V.1326 P.337

R=185.00'
Δ=63°16'08"
A=204.29'
C=194.06'
N-58°54'26"-E

FAIRWAY DRIVE 60'

S-62°43'38"-E
60.00'

125.20'
S-88°55'-E

N-0°32'30"-E
60.00'
97.98'
S-89°27'30"-E
203.99'
301.97'

51.97'
Z-89°27'30"-W

300.00'

5.3922 AC.

S-89°27'35"-E

589.91'

433.62'

60'

1058.66'

300.00'

ROAD

S-1°05'00"-W

325.04'

WHITEHEAD

#19322

APPROVED
LORAIN CO.
MAP DEPT.

DATE 4-2-91

PAGE 15-00-098 B

BY CAROLYN
FRANCIS

VOID
AFTER # 19322

587.08'

4.0529 AC.

N-0°32'30"-E

300.00'

120.00'

205.00'

N-0°32'30"-E

DATE OF SURVEY

S-89°27'40"-E

4.2893 AC.

N-89°27'30"-W

567.10'

60'

WEBSTER

ROAD

PREPARED BY:

JKS ASSOCIATES INC.
ENGINEERS & SURVEYORS

David L. Elwell

DAVID L. ELWELL

REG. SURV. NO. 6333

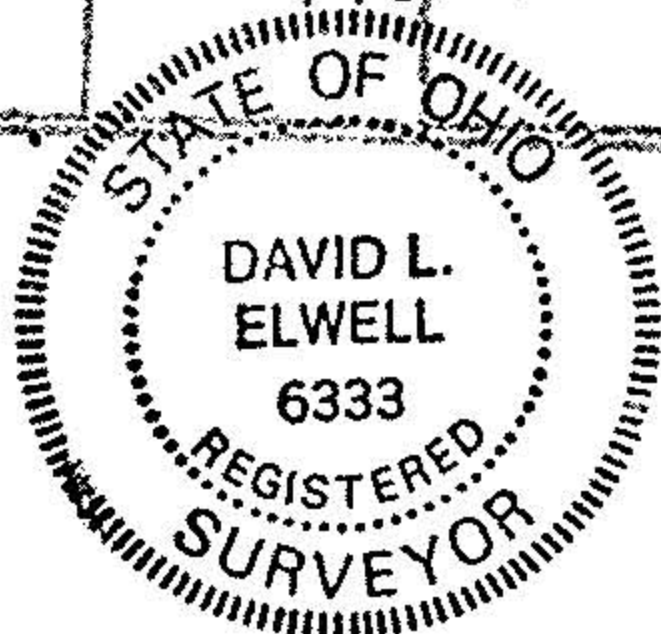

SURVEY MAP

PART OF LAGRANGE TOWNSHIP
ORIGINAL LOT NO. 98
TOWNSHIP OF LAGRANGE
COUNTY OF LORAIN
STATE OF OHIO

3-6-91

67-17-3

#19322

PHEASANT RUN VILLAGE PHASE I P.V. 27, P.P. 16-19

15-00-098

STABLE ROAD 60'

296



NORTH