

BOUNDARY SURVEY for RODNEY C. & MARY PATRICE KNAPP, AND MARGARET KNAPP

PART OF LOT 37, 38 and 47 IN TRACT 5, AND PART OF LOT 35 IN TRACT 4 OF ORIGINAL PENFIELD TOWNSHP, LORAIN COUNTY, OHIO.

MARCH 2001 FB 36-12 01001

REFERENCES: SURVEY FOR REAL ESTATE SHOWCASE BY T. SNEZEK P.S. 7051 DATED 1-28-01; SURVEYS BY NORM FRANK DATED OCT. 1976.

BASIS OF BEARINGS: NORTH 02° 20' 52" WEST ALONG THE NORTHERLY CENTERLINE OF FOSTER ROAD AS DEPICTED ON MAP, WITNESSED BY MONUMENTS FOUND; THE SAME BEARING USED IN SURVEYS BY NORM FRANK IN OCTOBER 1976.

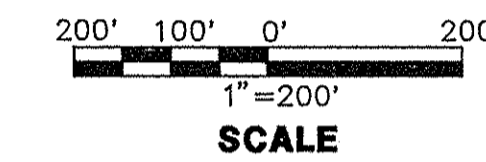

- LEGEND
- 5/8" REBAR CAP NO. 7265 SET;
 - RAILROAD SPIKES SET AT CENTERLINE OF ROAD.
 - MONUMENT FOUND AS NOTED.

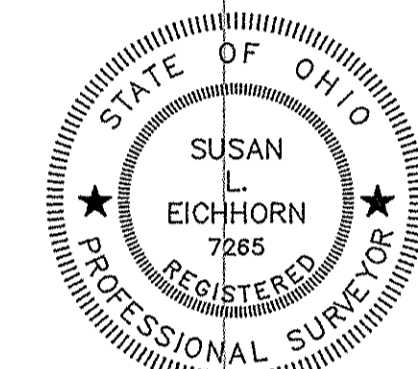

Susan L. Eichhorn 3-15-01
SUSAN L. EICHORN P.S. 7265 DATE

LOT 47 = 10.0000 AC.
 LOT 38 = 13.3300 AC.
 LOT 37 = 41.7924 AC.
 LOT 35 = 7.6266 AC.
 TOTAL = 72.7490 ACRES

P.P. NO. 19-04-035-000-004, 007, 018 19-05-37-000-005, 013, 014, 020, 017, 018, 015 19-05-38-000-026, 011, 022, 023, 004, 015 19-05-47-000-	
SPLIT #	DATE OF SURVEY Mar. 2001
MAP PAGE	
SURVEYOR Susan L. Eichhorn	