

20155

APPROVED
 LORAIN CO.
 MAP DEPT.
 DATE 11-20-92
 PAGE 11-F SOUTH
 BY CAROLYN
 FRANCIS
 VOID # 20155
 AFTER



Thomas P. Scott

Regina Reisinger ETAL
 Remainder by Auditor
 25.932 Acres

Donald & Cherry Combs
 OR 506 Pg 143

- Monument box
- Iron pipes fd
- Iron pipes set

-023 Kathleen Ferry Div. 1416 Pg 549
 Jean L Szczepanski Div. 1216 Pg 82

Survey for a Parcel Split
 Part of Original Lot 78
 Eaton Township
 Lorain County Ohio
 Scale 1" = 200' July 1992

John Pozzywak
 Reg Surveyor
 5292

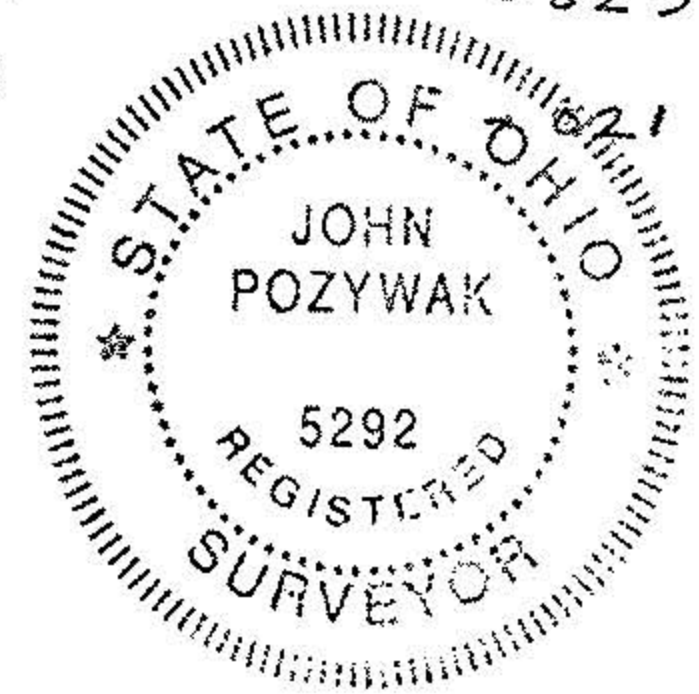

Paved over