



LAUNDON . SIMON . CAHL & ASSOC. INC.
CONSULTING ENGINEERS & SURVEYORS
ELYRIA, OHIO 44035

SURVEY FOR:

ALLEN MEMORIAL HOSPITAL

Orig. Lot 22	City of	Date 2-13-91	Scale 1"=100'
Orig. Sec	Village of WELLINGTON	Dwn. by R.G.S.	Chkd. by
Tract	County of LORAIN	Job No. 90-1967-2	F.B.
Township of WELLINGTON	State of OHIO	Printed NOV 20 1991	

24 MORNINGSIDE
ADD N. P.V. 7 P. 44
I.P.

DAVID J. & ELEANOR F.
PERSONS V. 1195 P. 477
N. 89° 32' 00" E. 400.02

DICKSON ST. 60'

1

2

3

4

5

6

7

8

EASTERN HEIGHTS SUBN
P.V. 14 P. 25

135.0
135.67
50.00
5.0° 12' 10" W. 352.90
601.67
2.0° 12' 10" E.

135.0
135.67
N. 89° 32' 00" E.

265.02
5.0° 26' 00" E.
60.00

85.67

DICKSON ST. (PROPOSED)
0.1864 Ac.

PARCEL No 1
3.2158 Ac.

- 017

EX. ST. SWR. EASMT. TO VILL. OF WELLINGTON
I.P. 5.89° 47' 50" E.
350.00

PARCEL No 2
2.6942 Ac.

400.00
N. 89° 47' 50" W.

REV. 4-24-91



JAMES M. LAWSON
V. 1377 P. 641

19692

APPROVED
LORAIN CO.
MAP DEPT.

DATE 12-11-91
PAGE 18-00-022-B
BY CAROLYN FRANCIS
VOID AFTER # 19692

DELBERT & LOIS
V. 1219 P. 926

18-00-022-115
19692
18-00-022-B



LAUNDON . SIMON . CAHL & ASSOC. INC.
CONSULTING ENGINEERS & SURVEYORS
ELYRIA, OHIO 44035

SURVEY FOR:

ALLEN MEMORIAL HOSPITAL

Orig. Lot 22	City of	Date 2-13-91	Scale 1"=100'
Orig. Sec	Village of WELLINGTON	Dwn. by R.G.S.	Chkd. by
Tract	County of LORAIN	Job No. 90-1967-2	F.B.
Township of WELLINGTON	State of OHIO	Printed NOV 20 1991	

24 MORNINGSIDE
ADD N. P.V. 7 P. 44
I.P.

DAVID J. & ELEANOR F.
PERSONS V. 1195 P. 477
N. 89° 32' 00" E. 400.02

DICKSON ST. 60'

1

2

3

4

5

6

7

8

EASTERN HEIGHTS SUBN
P.V. 14 P. 25

135.0
135.67
50.00
5.0° 12' 10" W. 352.90
601.67
2.0° 12' 10" E.

135.0
135.67
N. 89° 32' 00" E.

265.02
5.0° 26' 00" E.
60.00

85.67

DICKSON ST. (PROPOSED)
0.1864 Ac.

PARCEL No 1
3.2158 Ac.

- 018

EX. ST. SWR. EASMT. TO VILL. OF WELLINGTON
I.P. 5.89° 47' 50" E.
350.00

PARCEL No 2
2.6942 Ac.

400.00
N. 89° 47' 50" W.

REV. 4-24-91

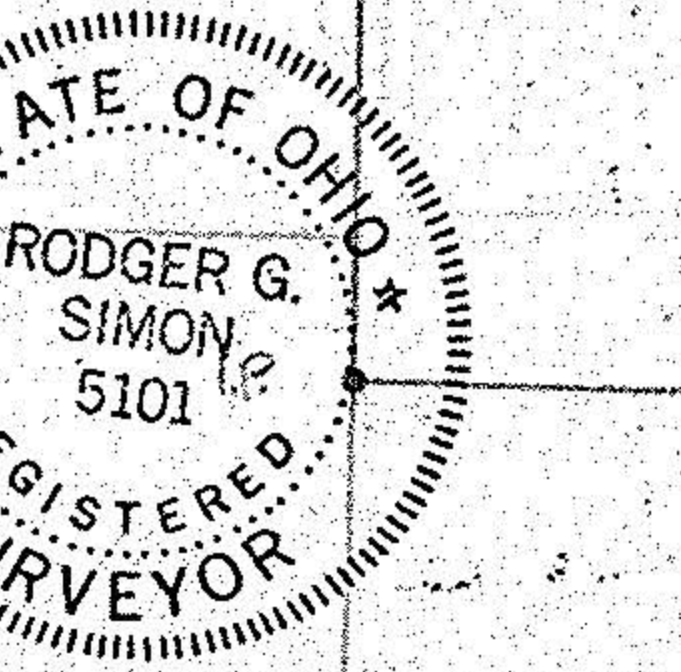

JAMES M. LAWSON
V. 1377 P. 641

19692

APPROVED
LORAIN CO.
MAP DEPT.

DATE 12-11-91
PAGE 18-00-022-B
BY CAROLYN FRANCIS
VOID AFTER # 19692

DELBERT & LOIS
V. 1219 P. 926

18-00-022-115
19692
18-00-022-B