

SURVEY MAP #18770
PART OF

EATON TOWNSHIP ORIGINAL LOT 18 IMPROVED
 VILLAGE OF GRAFTON COUNTY OF LORAIN
 STATE OF OHIO
 MAP DEPT.

PREPARED BY:
KS ASSOCIATES INC.
 ENGINEERS & SURVEYORS

DATE	12-14-89
PAGE	11-00-081
BY	CAROLYN FRANCIS
VOID AFTER #	18770

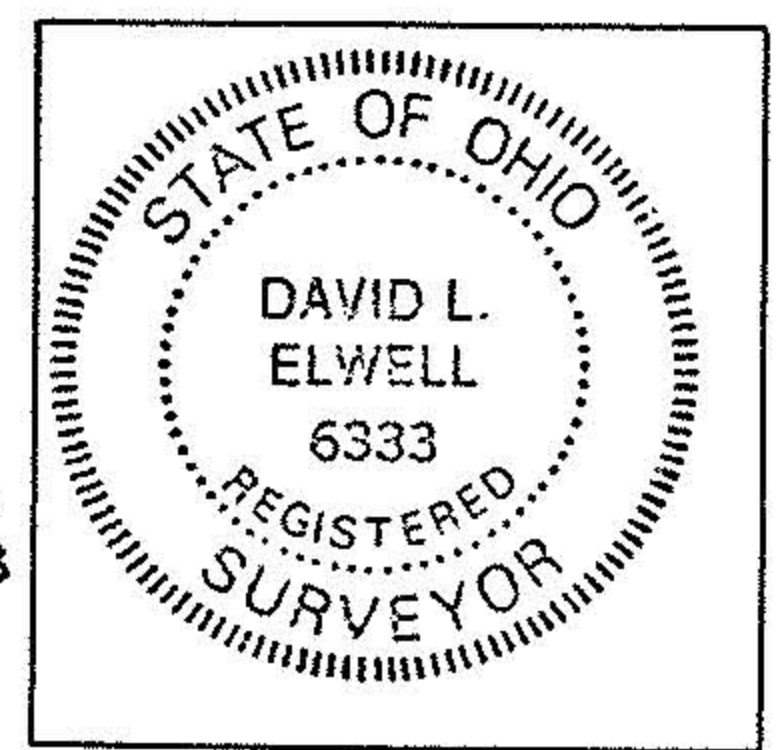

David L. Elwell
 DAVID L. ELWELL REG. SURV. 6333