

I the undersigned, JERRY E. STEADMAN, owner of the land shown on this plat hereby accept this plat and subdivision of the same.

Jerry E. Steadman Date 11-15-91
 State of Ohio } S.S.
 County of Cuyahoga }

Before me, a Notary Public in and for said county and state, personally appeared the above signed Jerry E. Steadman, who acknowledged the signing of the foregoing instrument to be his own free act and deed.

In witness whereof I have hereunto set my hand and official seal this 15th day of November, 1991.

William J. Dempsey
 NOTARY PUBLIC
 MY COMMISSION EXPIRES 11-23-93

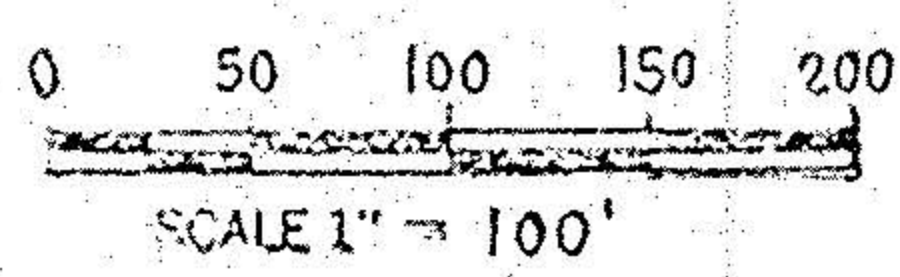
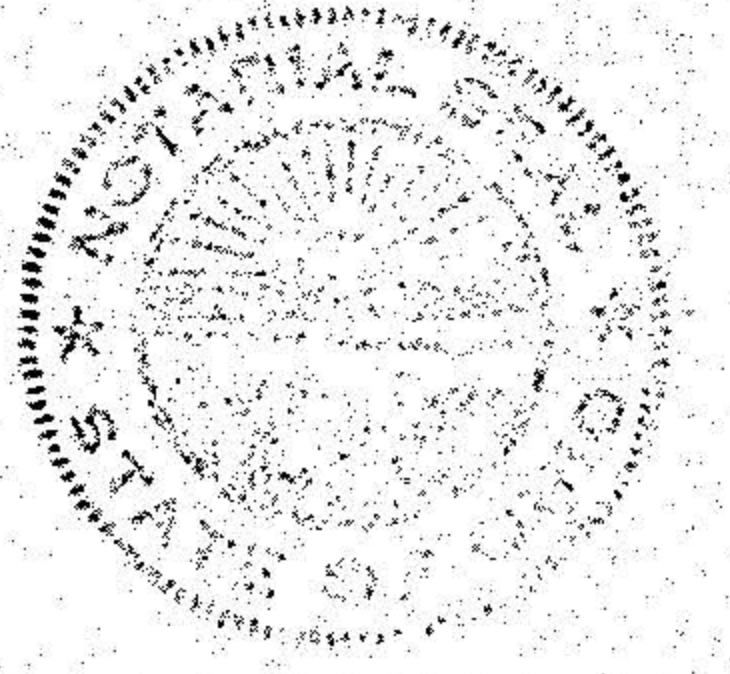

MAP OF SURVEY
 for
 R. PATRICK BAUGHMAN

Being a part of Columbia Township Lots Nos. 48 and 49.

Dimensions are given in feet and decimals.

Scale 1" = 100"

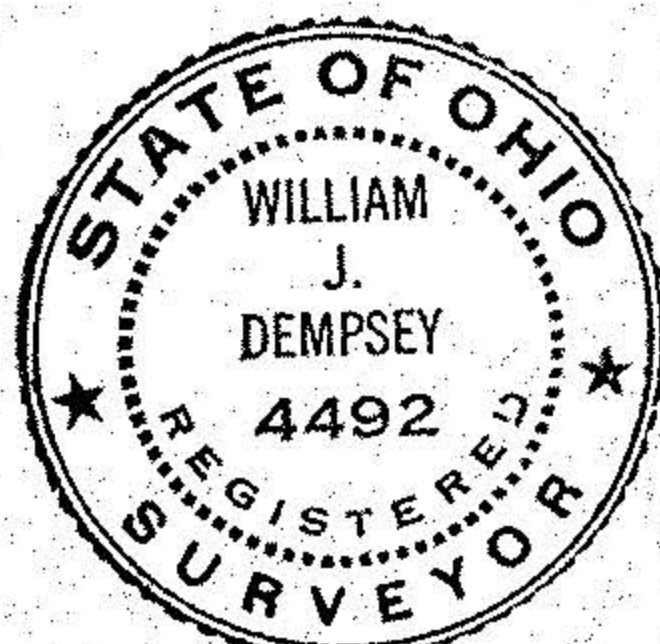

by: Dempsey & Associates, Inc.
 Professional Surveyors
 3657 West 117th Street
 Cleveland, Ohio 44111
 Phone: (216) 252-1800

William J. Dempsey
 William J. Dempsey PS 4492

November 13, 1991

MAP NO. 1736
 O. 3997
 FB. 110, P. 31-88

15-00-018-000
 000-810-00-57