

06-23-008-106

WESTERLY LINE OF  
CITY OF ELYRIA CORP.  
16 AUGUST 1965 BY CITY  
RESOLUTION ORDINANCE  
NO 65-113 VOL 913  
P. 365 DEEDS.

N 89° 46' E 223.21'

SCHADGN ROAD

KEEP COURT V25A79 PLATS

WEST

NORTH 7284

06-23-008-106-016-67  
088108  
009 22  
Total → 1.97

N 89° 33' E 1437.74

S 89° 33' W 1419.86

6-25

6-26

Total Ac St. Deed 1.97

PROPOSED 60 ROADWAY  
TO CITY OF ELYRIA 1.97 ACRES

N.E. CORNER O.L. # 9

SEE  
P.D. 72.165

6-25  
6-26

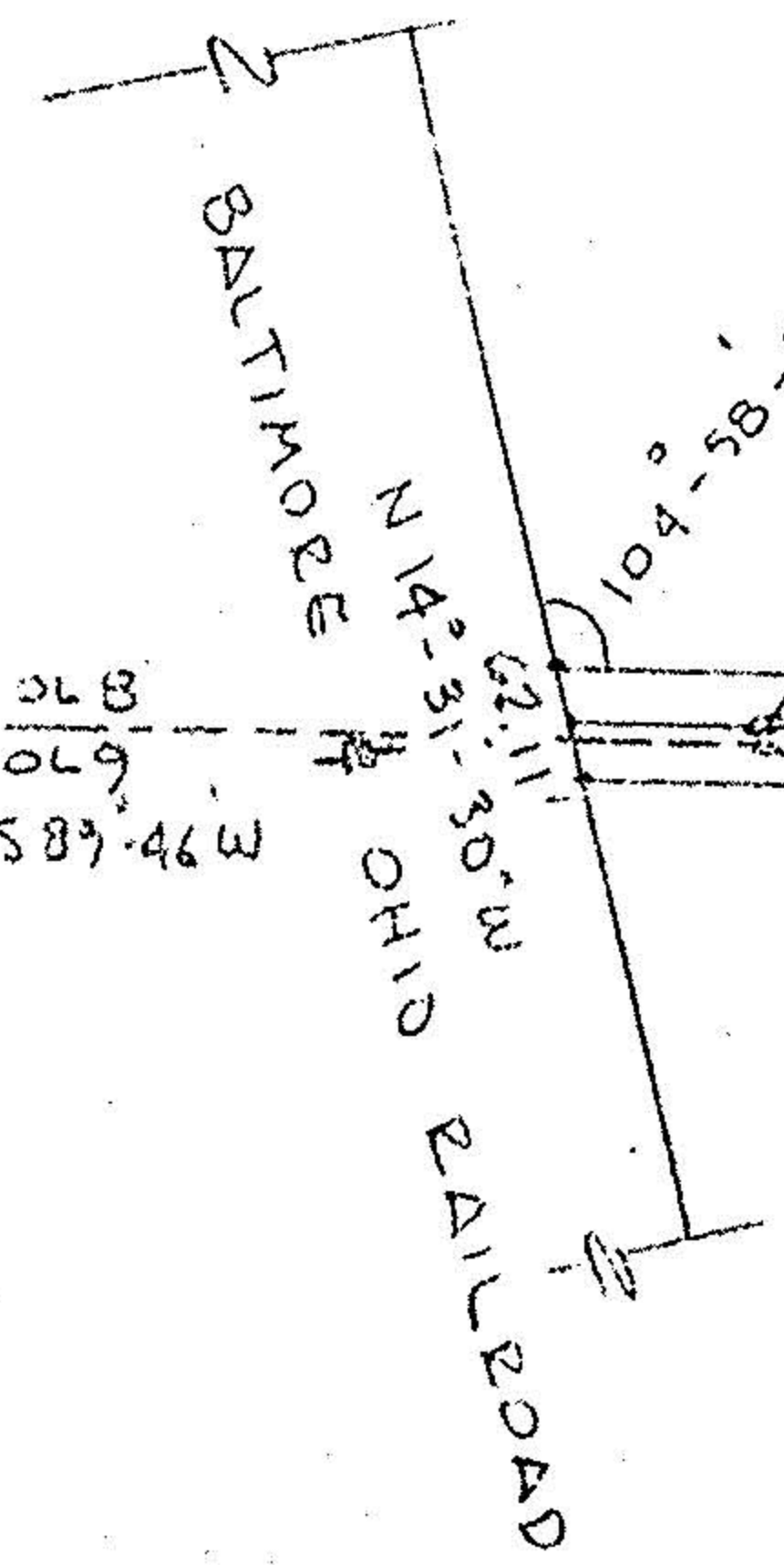

### MILAN STEEL INDUSTRIES

BRACE TRACT WEST OF BLACK RIVER  
N.E. CORNER ORIGINAL LOT # 9  
S.E. CORNER " " LOT # 8  
LORAIN COUNTY OHIO

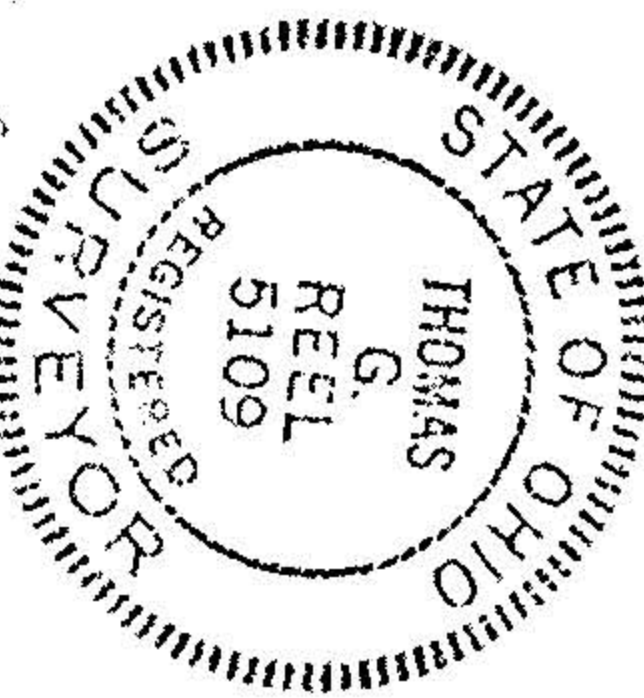

Thomas G. Reel  
APRIL 1973  
SCALE 1" = 200.0'

FILE # 641 J.

THOMAS G. REEL, P.E. ENGINEER/SURVEYOR, MILAN, OHIO