

P.P. NO. 11-00-017-000-034, 033, 035	
SPLIT # 109850	DATE OF SURVEY
MAP PAGE 11-H	
SURVEYOR DONALD E. HIMES.	

5-22-92 19922  
19850

APPROVED  
LORAIN CO.  
MAP DEPT.  
DATE APR - 8 1992  
PAGE 11-H  
BY CAROLYN FRANCIS  
VOID AFTER # 19850

**PLAT OF SURVEY & PARCEL SPLIT**

MADE FOR: JONEL MAGDA D.R. VOL. 127, PG. 166

BEING A PART OF LOT N<sup>o</sup> 17 OF EATON TOWNSHIP  
LORAIN COUNTY OHIO

I DECLARE THIS PLAT TO BE A TRUE REPRESENTATION OF AN ACTUAL FIELD SURVEY MADE BY ME IN JANUARY, 1992, AND CORRECT TO THE BEST OF MY KNOWLEDGE AND BELIEF. DISTANCES ARE GIVEN IN FEET AND DECIMAL PARTS THEREOF. NORTH DATUM USED IS THE BEARING OF RECORD FOR THE CENTERLINE OF REED ROAD.

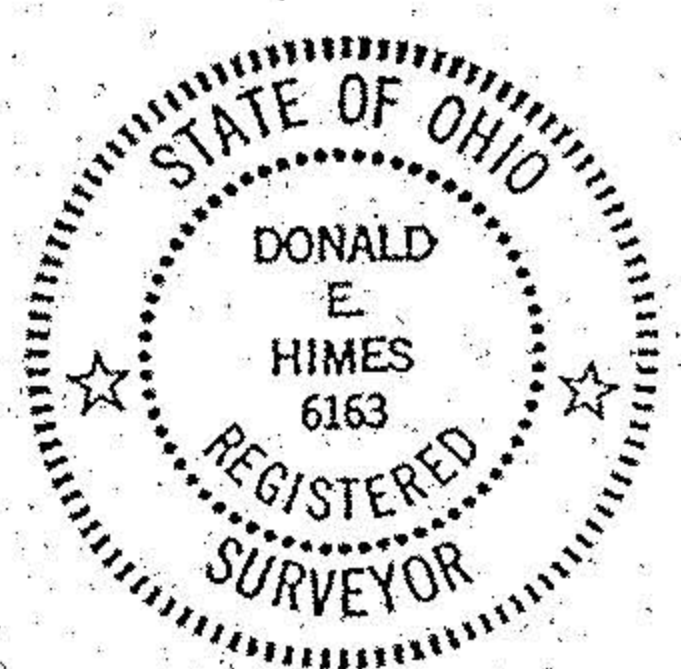

**Donald E. Himes & Associates**  
SITE CONSULTANTS • LAND SURVEYORS

14776 Pearl Road, Strongsville, Ohio 44136  
Telephone: (216) 572-2685 or 238-2685

*Donald E. Himes* 1/31/92

