

HAWKE ROAD

S.R.-82 253.00'

S 85°26'45" E 260.00'

55.00' 90°11'00"

I.P. SET

R/W

I.P. SET

55.00'

MONUMENT
K.A. McCartney 5/31/91
WEST
EAST LINE
LOT 95

CHARLES J AND MARY LUE RUBEL
VOL. 1076, PAGE 72

N 4°44'15" E 280.08'

2.00 AC.

S 4°44'15" W 280.08'

335.08'

#19397

APPROVED
LORAIN CO.
MAP DEPT.

DATE 5-30-91

PAGE 12-E

BY CAROLYN FRANCIS

VOID # 19397
AFTER

PLAT OF SURVEY TO LOCATE AND
DESCRIBE A PORTION OF A TRACT OF
LAND CONVEYED TO RICHARD P. WADE

BY DEED RECORDED IN VOLUME 77
PAGE 744 OF THE LORAIN COUNTY
RECORD OF DEEDS.

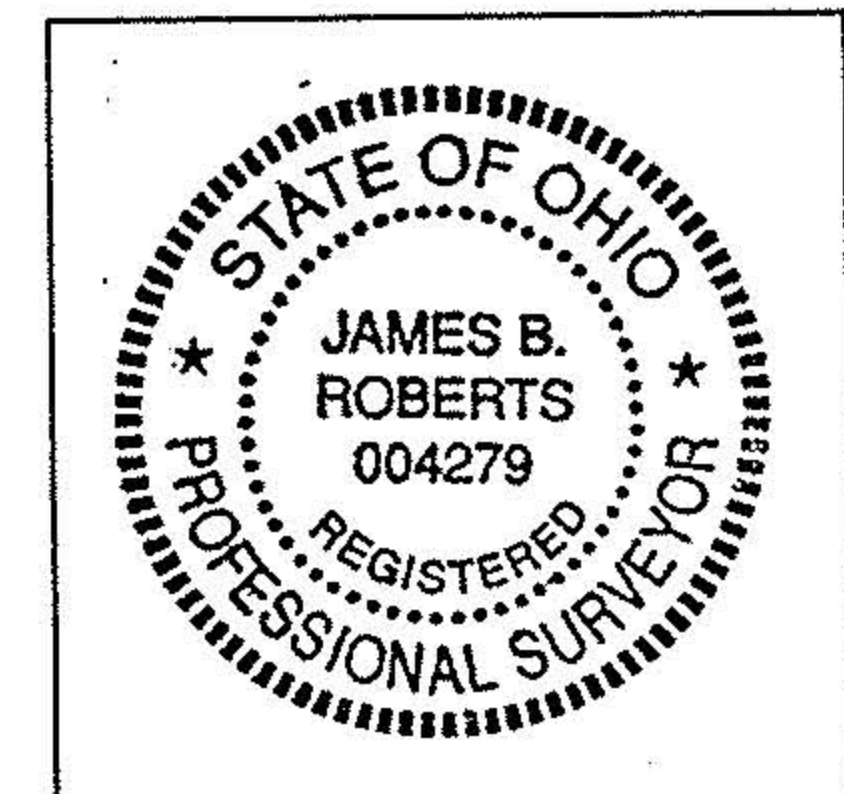

RICHARD P. WADE
60.680 AC.
VOL. 77 PAGE 744

- SYMBOLS
- RAILROAD SPIKE FOUND
 - IRON PIN FOUND
 - RAILROAD SPIKE SET
 - IRON PIN SET

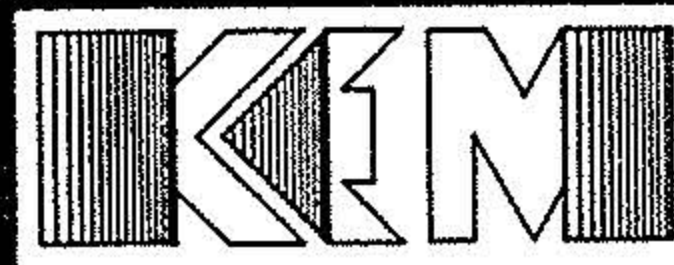

K. E. MCCARTNEY & ASSOCIATES
MANSFIELD, OHIO

LOT NO. 95
COLUMBIA TOWNSHIP,
LORAIN COUNTY, OHIO

DRAWN BY M.J.S.	DATE MAY 5, 1991	SCALE 1"=50'
--------------------	---------------------	-----------------

I HEREBY CERTIFY THIS PLAT TO BE A
TRUE DELINEATION OF A FIELD SURVEY
BY K.E. MCCARTNEY & ASSOCIATES,
[Signature]
MAY 1991
REGISTERED SURVEYOR NO. 4279