

BERNARD G. & BETH ANN BORATO
D.V. 1355 P. 815

MARY MUTSCHLER
O.R.V. 77 P. 600

144

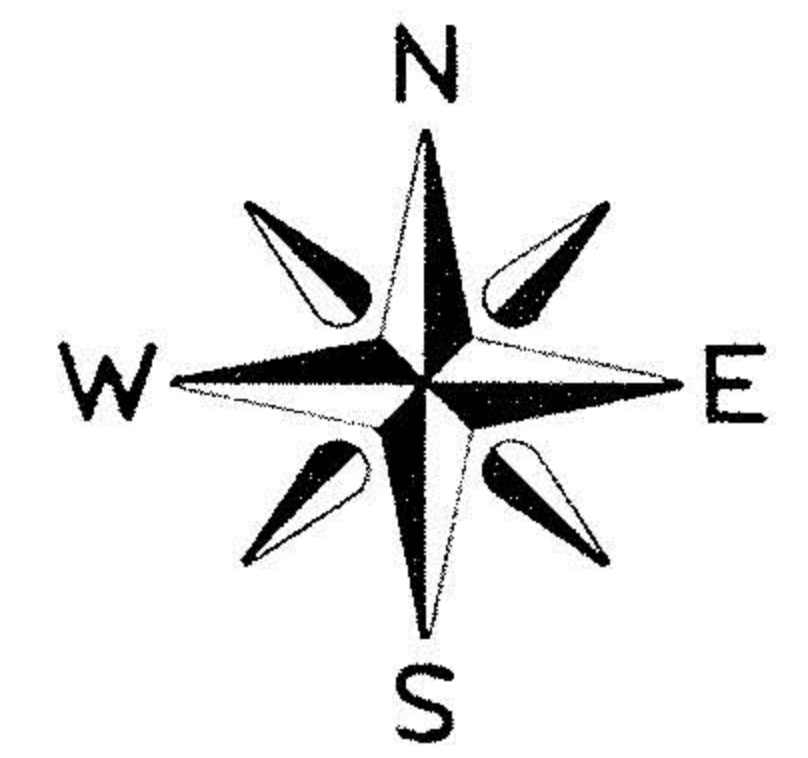

SCALE: 1" = 50'

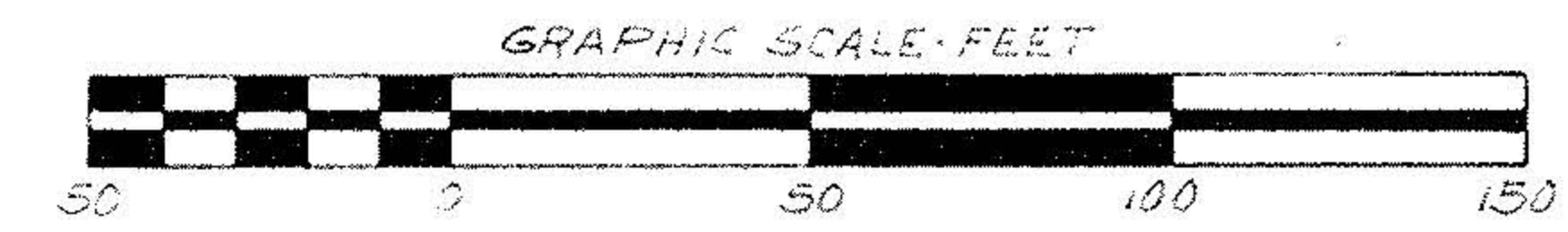

LESLIE JACK SMITH
O.R.V. 392 P. 127

AZALEE BREEDLOVE, PATRICIA A. LOWRIE, BRUCE BREEDLOVE
O.R.V. 164 P. 629

4.9998 AC.
(4.1734 AC.)

(A)

143

142

141

140

139

138

CENTER GATE MILLS SUBD. NO. 3
P.V. 5-7

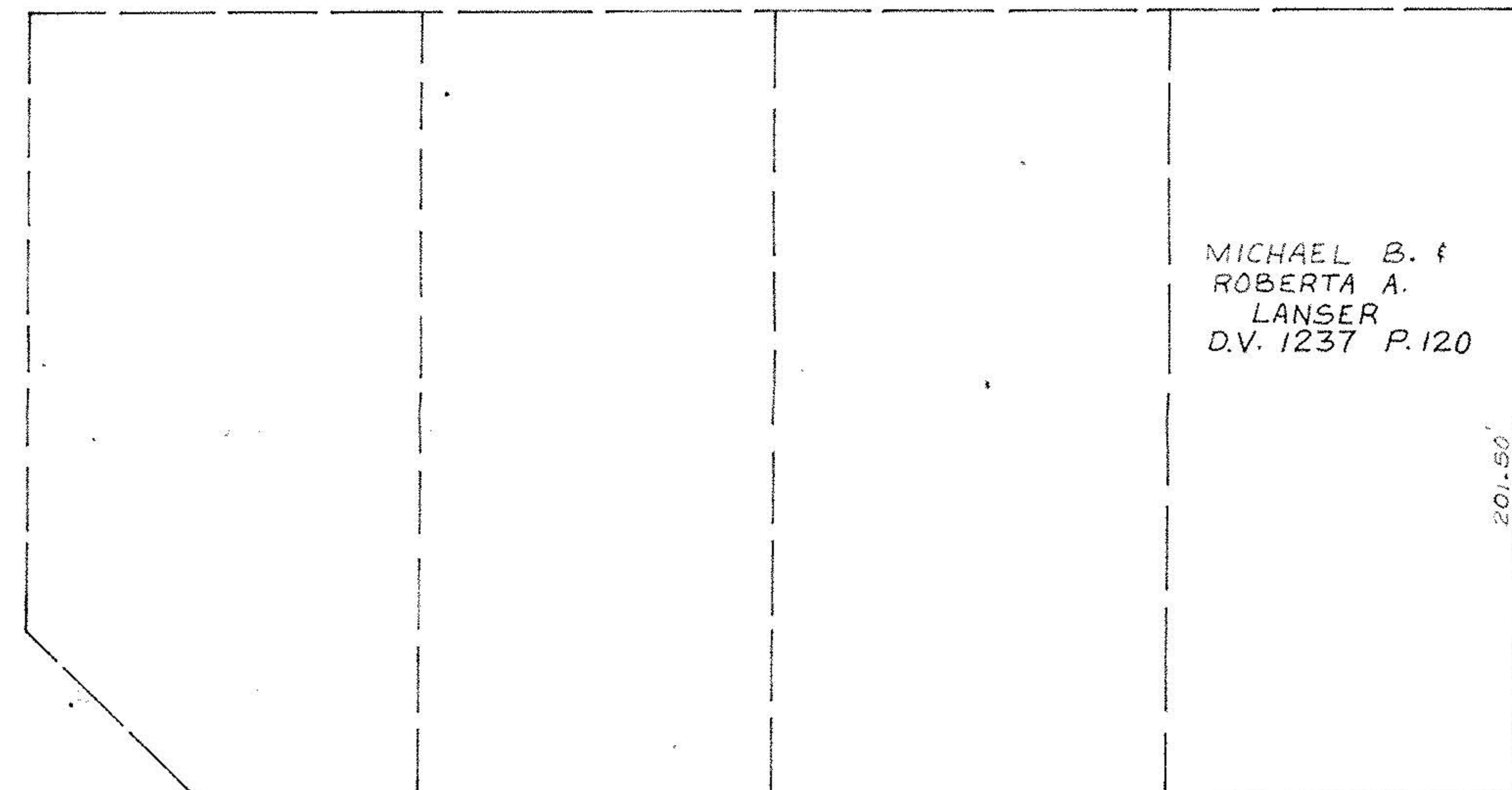

MICHAEL B. &
ROBERTA A.
LANSER
D.V. 1237 P. 120

S-89°36'-W 180.00'

90.00' 90.00'

(0.4132 AC.)

(C)

(0.4132 AC.)

(B)

N-0°03'30"-E
510.66'

201.50'

200.00'

N-0°03'30"-E
200.00'

200.00'

N-0°03'30"-E
200.00'

200.00'

510.66'

S-0°03'30"-W

426.50'

90.00'

90.00'

246.50'

66.36'

(FORMER BLOCK "A")

CITY OF NORTH RIDGEVILLE D.V. 1032 P. 224

LEWIS STREET 20'

OLIVE AVE. 40'

54

51

(Y)

WALLACE BLVD. 40'

51

61

(X)

(W)

CORNELL AVE. 40'

62

61

60

(V)

105
CENTER GATE MILLS SUB. 2
P.V. 32 P. 46-48

19843

APPROVED
LORAIN CO.
MAP DEPT.

DATE 4-2-92

PAGE 7-00-018 B

BY CAROLYN

FRANCIS

VOID # 19843

AFTER

07-00-018-101-

CLEVELAND ROAD HOMESITE ALLOTMENT
P.V. 10 P. 27 & 28

BOUNDARY SURVEY

PART OF RIDGEVILLE TOWNSHIP ORIG. LOT 18
CITY OF NORTH RIDGEVILLE, COUNTY OF LORAIN
STATE OF OHIO

SCALE: 1" = 50'

DECEMBER, 1991



David L. Elwell
DAVID L. ELWELL - REG. SURV. 6333



91-427