

10-00-005-101-445
ELYRIA EAST LITTLE LEAGUE INC.
O.R.V. 259 P. 563

(ORD. NO. 79-266 10-15-79)
N 89°49'00" E 276.02'

VILLAS AT HIGHLAND PARK CONDO.
PHASE 3 P.V. 53 PP. 27-29

(ORD. NO. 90-272)
CITY OF ELYRIA

CARLISLE TWP.

10-00-005-101-062
MARY K. NOONAN
O.R.V. 637 P.885
3.75 AC.

CARLISLE TWP.

(PARCEL ANNEXED TO CITY OF ELYRIA BY RES. NO. 94843)
HELEN N. COLLINS D.V. 1123 P. 208
CITY OF ELYRIA 10-00-005-101-013
S 00°11'00" E
547.66'

10-00-005-101-190
ELYRIA EAST LITTLE LEAGUE INC.
O.R.V. 749 P. 730

**PROPOSED ANNEXATION
TO THE
CITY OF ELYRIA
4.3492 ACRES**

10-00-005
-101-063
CITY OF ELYRIA
O.R.V. 166 P. 82

CHESTNUT RIDGE HTS.
SUBD. NO. 1
P.V. 29 PP. 70,71
S/L 35 S/L 34
N 84°32'54" E
70.00'

RALPH FOX
O.R.V. 735 P. 427

VILLAS AT HIGHLAND
HIGHLAND PARK CONDOMINIUMS
PHASE 4 P.V. 53 PP. 59-61

HIGHLAND DEV. CO.
O.R.V. 828 P. 632

HIGHLAND DEV. CO.
O.R.V. 828 P. 634

573.22'

10-00-005
-101-539

10-00-005
-101-540

10-00-005
-101-426

141.64'

88.77'

N 80°05'44" E
60.01'

S 80°05'44" W
140.60'

CARLISLE TWP.

S 84°32'54" W 21980.429721'

CITY OF ELYRIA

S 00°11'00" E
60.25'

APPROVED
LORAIN CO.
MAP DEPT.
DATE 12-13-96
PAGE 10-00-0058
BY R. BELL
VOID AFTER # 21980-X

10-00-005-107-140
HIGHLAND DEVELOPMENT CO.
O.R.V. 782 P. 392
PARCEL NO. 2

10-00-005-107-129
HIGHLAND DEVELOPMENT CO.
O.R.V. 782 P. 392
PARCEL NO. 1

ANNEXATION MAP

PART OF ORIG. CARLISLE TOWNSHIP
SECTION NO. 5
TOWNSHIP OF CARLISLE COUNTY OF LORAIN
STATE OF OHIO
JUNE 17, 1996

PREPARED BY:
KS ASSOCIATES INC.
ENGINEERS SURVEYORS



SCALE IN FEET
1" = 100'

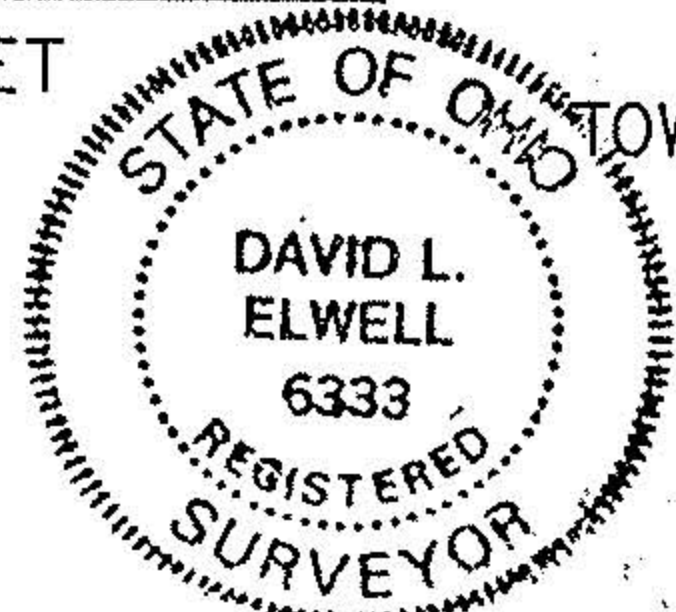

David L. Elwell
REGISTERED SURVEYOR NO. 6333