

# BOUNDARY SURVEY

EATON TOWNSHIP ~ LORAIN COUNTY ~ STATE OF OHIO  
PART OF ORIGINAL EATON TOWNSHIP LOT NO. 98

WALTER AND MARIE RADER

PPN 11-00-098-000-017 & -016 ~ DEED VOL. 680 PG. 275 & DEED VOL. 566 PG. 256

APRIL 2003

11-00-098-000-015  
WILLIAM W. & HENRIETTA WASIL  
D, VOL. 566 PG. 258

11-00-098-000-016  
WALTER & MARIE RADER  
D. VOL. 680 PG. 275

SPLIT PARCEL NO. 1  
1.1125 ACRE TO C/L

S89°41'39"W  
339.50' M.

SPLIT PARCEL NO. 2  
0.3709 ACRE TO C/L

COMBINATION PARCEL  
1.1128 ACRE TO C/L

11-00-098-000-017  
WALTER & MARIE RADER  
D. VOL. 566 PG. 256  
0.7419 ACRE

EATON TWP.  
ORIG. LOT. 98  
S89°41'39"W  
339.62' M.

ORIG. LOT 99  
GRAFTON VILLAGE

BLOCK A  
KING INC.

FOX RUN SUBDIVISION

MEDINA-ELKRIA ROAD 57  
STATE ROUTE 57  
60' R/M

FOX RUN (60')

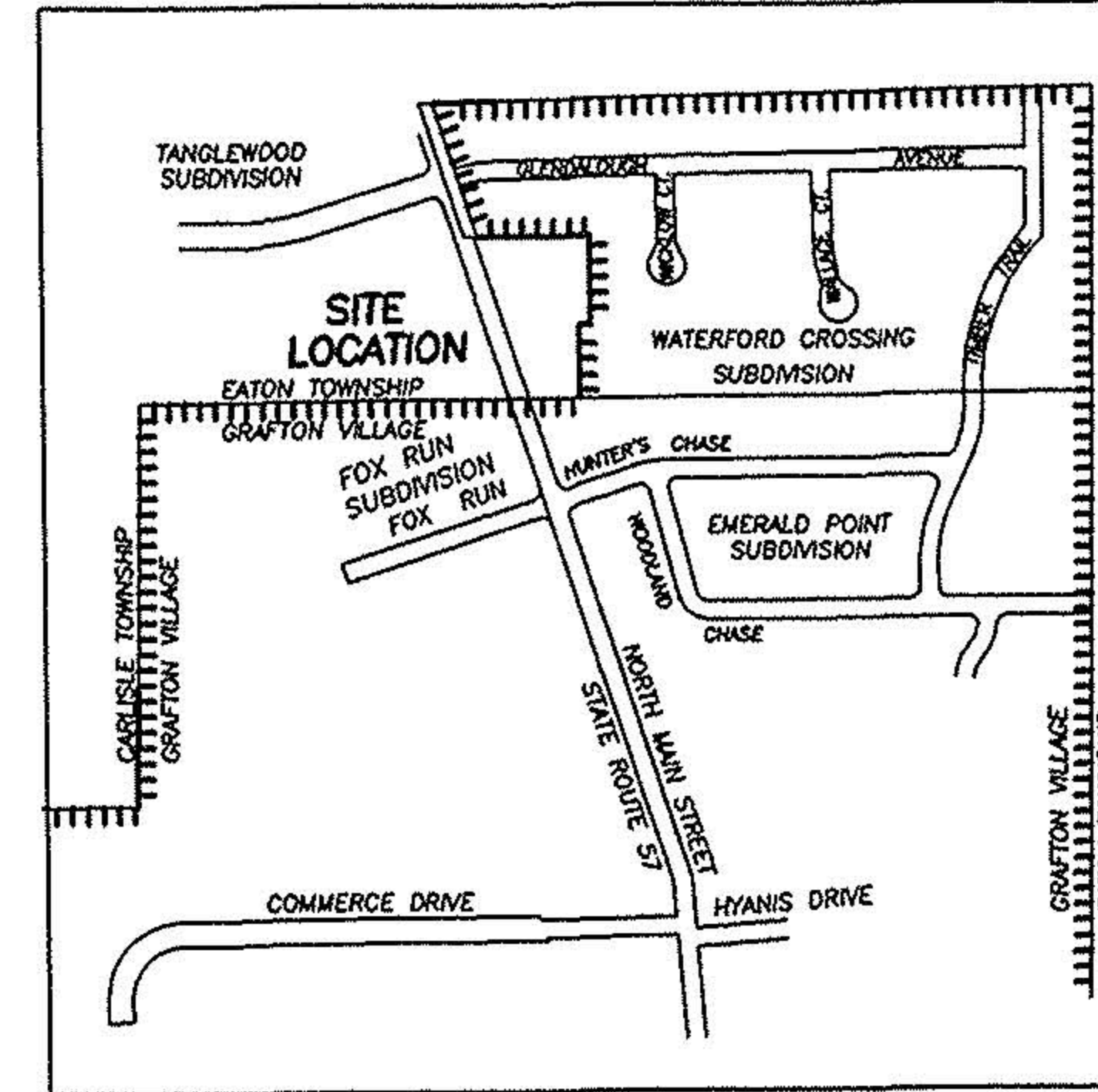

### SURVEYOR'S CERTIFICATION

THIS IS TO CERTIFY THAT AT THE REQUEST OF THE OWNERS I HAVE SURVEYED AND PLATTED 2.2253 ACRES OF LAND AS SHOWN HEREON IN ORIG. EATON TOWNSHIP LOT NO. 98, TOWNSHIP OF EATON, COUNTY OF LORAIN, STATE OF OHIO. DISTANCES ARE SHOWN IN FEET AND DECIMAL PARTS THEREOF. BEARINGS SHOWN ARE ASSUMED AND USED TO DESCRIBE ANGLES ONLY. ALL OF WHICH I CERTIFY TO BE CORRECT.

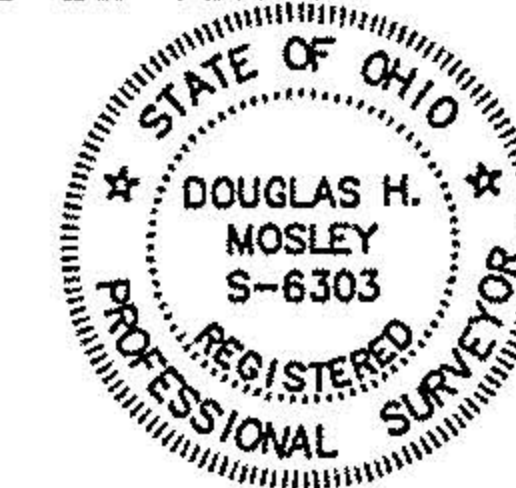

*Doug Mosley*  
6/11/03

### LEGEND

- ⊙ IRON PIN FOUND-AS NOTED
- 1/2" CAPPED REBAR SET
- R ~ RECORDED DISTANCE
- M ~ MEASURED DISTANCE

**HAYWOOD**  
Civil Engineering & Land Surveying  
"Committed to Service and Quality"

630 Cleveland Street Office: (440) 385-9831  
Elyria, Ohio 44035 Fax: (440) 385-3428  
www.haywoodcivilengineering.com

### GRAPHIC SCALE



( IN FEET )  
1 inch = 50 ft.

S/L 51  
THOMAS R. & RENEE M.  
LAUBENTHAL

TANGLEWOOD SUBD. NO. 2  
P.V. 61 PG. 49-50

5/8" REBAR  
FOUND

3/4" IRON PIN  
FOUND

1" IRON PIN  
FOUND

3/4" IRON PIN  
FOUND

3/4" IRON PIN  
FOUND

1" IRON PIN  
FOUND

1" IRON PIN  
FOUND

1" IRON PIN  
FOUND

1" IRON PIN  
FOUND

200.00' R. & M.  
N18°10'37"W  
150.00' M.

150.00' M.  
N18°10'37"W  
100.00' R. & M.

100.00' R. & M.  
N18°10'37"W  
150.00' M.

339.39' M.  
N89°41'39"E

31.53' M

150.04'  
S18°13'30"E

31.53' M  
S18°13'08"E

31.53' M  
S50°01' W

31.53' M  
S18°13'30"E

100.30' W  
S18°13'30"E

31.53' M  
42.04' R.

334.93' R.

367.83' R.