

LOT SPLIT PLAT
of
KRUKEMEYER PROPERTY

Being known as part of Original Columbia Township Lot No. 24:

COLUMBIA TOWNSHIP
COUNTY OF LORAIN - STATE OF OHIO

by
McSTEEN & ASSOCIATES, INC.
ENGINEERS & SURVEYORS
26451 CURTISS WRIGHT PARKWAY
RICHMOND HEIGHTS, OHIO
(216) 797 - 9800

Bearings shown hereon are to an assumed meridian and are used to denote angles only. Distances are given in feet and decimal parts thereof. All iron pins shown as set are 30" long 1/2" rebar with an identification cap stamped "McSteen 7104".

[Signature]
TIMOTHY J. FELLER
REG. PROF. SURVEYOR # 7104
JOB No. 99-293
JUNE 2000

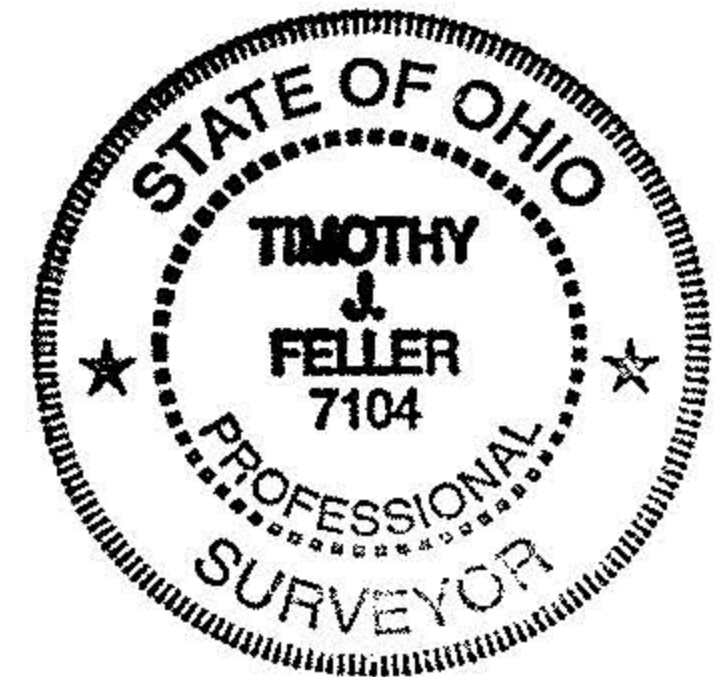

HEATHER LANE SUBDIVISION
VOL. 56 PGS. 31 & 32 L.C.M.R.

WILLIAM J. WIECHEC
PP #12-00-023-000-017
INSTR. #970481489
PARCEL NO. 2

50' DITCH
EASEMENT
1/2" PIN
FND. & USED

1149.84' REC. & OBS.

1" PIPE
FND. & USED
0.80' N.

N 89°50'36" W
588.13 OBS. 583.64' DEED' O.L. 23
603.07' OBS. 604'+/- DEED O.L. 24

1" PIN
FOUND
0.46' N.

8" NAIL
FOUND
AND USED

DENNIS A. SELBY
PP #12-00-024-000-001
VOL.1193, PG.41
PARCEL NO. 21

LOT 1
AREA
429,498 sq.ft.
9.8599 acres

S 89°33'17" E 562.30' DEED & USED

1/2" IRON PIN
SET No. 7104

1" PIPE
FND. & USED

N 01°33'58" E 351.77' OBS. 352.31' DEED

20' effluent easement
N 51°33'17" W
310.00'

1/2" IRON PIN
SET No. 7104

No. 00676-A
APPROVED
LORAIN CO.
MAP DEPT.
DATE 3-11-02
PAGE 12-00-001-A
BY R. Maines
REV 02-00676-A

MARTIN G. MOLE
DONNA J. MOLE
PP #12-00-024-000-002
VOL. 905 PG. 85
PARCEL NO. 2



THOMAS KRUKEMEYER
PP #12-00-024-000-003
INSTR. NO. 000671337

N 89°33'17" W
1038.14'

N 01°19'52" E 540.76' OBS.
350.00'

1/2" IRON PIN
SET No. 7104

N 89°33'17" W
130.00'
S 00°26'43" W
50.00'
1/2" IRON PIN
SET No. 7104

LOT 2
AREA
415,106 sq.ft.
9.5295 acres

1 1/2" PIPE
FND. & USED

3/4" PIN 0.17' N. 0.05' W.
3/4" PIN 0.17' N. 0.11' E.

N 89°33'17" W 798.31' DEED
1167.85' OBS.

3/4" PIN
FOUND
0.62' W.

3/4" PIPE
FND. & USED

JOSEPH MITCHELL PIVOWAR, TRUST
PP #12-00-024-000-004
INSTR. #980557952

ADA E. WALLER
PP #12-00-024-000-005
VOL. 428 PG. 393

SNELL ROAD

1629.94' REC.

495.53'

895.53' OBS.

S 01°15'41" W
400.00'

BOONE ROAD 60'

GRAPHIC SCALE

