

PLAT OF BOUNDARY SURVEY
KENNETH J. & JUDITH A REED
 PART OF ORIGINAL LOT 6, TRACT 1
 TOWNSHIP OF PENFIELD, LORAIN COUNTY, OHIO

N 89°58'56" E 252.73' BRG: N 89°58'56" E
 DIST: 0.93'



BEARINGS
 ARE
 ASSUMED.
 ERROR OF CLOSURE IS
 LESS THAN 1:10,000.

SCALE 1"=60'

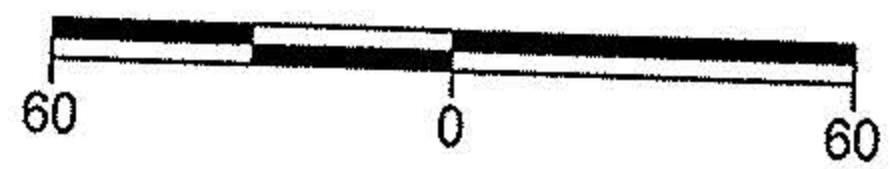

-007
 R. T. & E. I. REED, TRUSTEES
 INS. 20000725445

-008
 KENNETH J. & JUDITH A. REED
 D.V 1368, PG. 89 & O.R.V. 206, PG. 317

TOTAL AREA 3.0188 acres

Legend

- X Survey Corner, No Monument Found or Set
- Iron Pipe Found
- ◇ Iron Bar Found
- ⊙ Magnetic PK Spike Set
- ▲ 5/8" Iron Pin Set with Cap Stamped "Kelser 7871"

N 0°00'07" W

523.12'

S 0°17'48" W

523.17'

9' TO EAST LINE OF O.L. 6

REF. = 30.13'

REF. = 30.00'

250.00'

SOUTH LINE OF O.L. 6

S 89°59'30" W

SMITH ROAD

POB

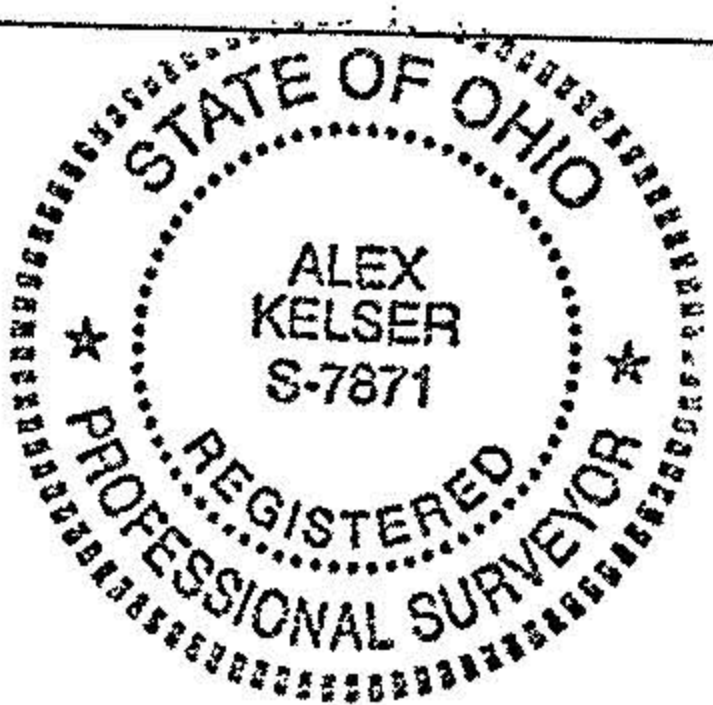

LAUNDON • SIMON • KELSER & ASSOC., INC.
 PROFESSIONAL LAND SURVEYORS
 110 MIDDLE AVE. • ELYRIA, OHIO • 44035
 PHONE (440) 322-7625

Alex Kelser
 Alex Kelser RLS #7871

DATE:	5/14/04
OB NO.:	04-3706