

June 1, 1976
Scale 1" = 200'

PLAT SHOWING SURVEY OF
2.00 ACRES
PART OF TRACTS 10 & 14
HUNTINGTON TOWNSHIP
LORAIN COUNTY, OHIO

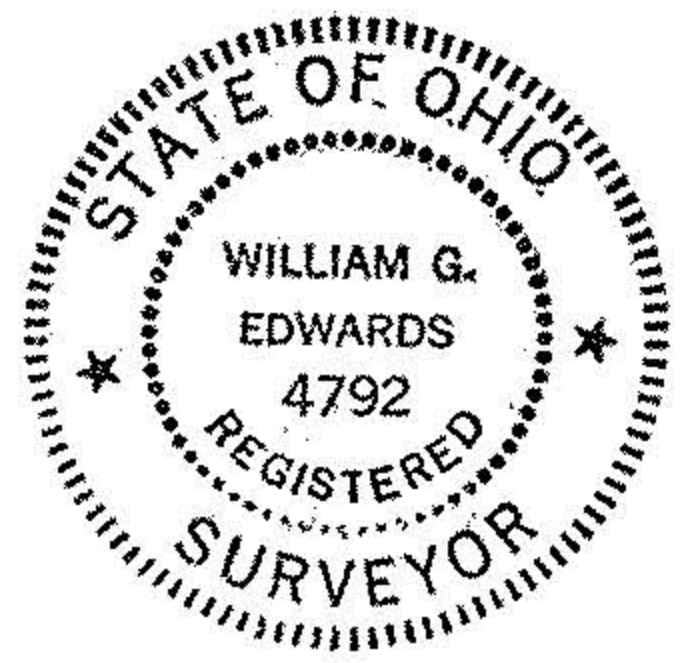

SURVEYED BY: William G. Edwards
WILLIAM G. EDWARDS
REGISTERED SURVEYOR No. 4792

085

21-10-000-000-026
 21-G
 000-000-01-15
 21-10-000-000-026