

DESCRIPTION

Situated in the Township of LaGrange, County of Lorain and State of Ohio and known as being part of Original Lot No. 35 of said township, bounded and described as follows:

Beginning at a point in the centerline of State Route 301 at its intersection with the centerline of Biggs Road; said point also being the Northwestern corner of Original Lot No. 35.

Thence in the centerline of State Route 301, South 0° 20' 35" East, a distance of 1224.68 feet to a point at a Southwesterly corner of land conveyed to Seabold Brothers, an Ohio Partnership, as recorded in Official Record Volume 1395, Page 768 of the Lorain County Records.

Thence in the Southerly line of said Seabold Brothers' land, North 89° 12' 58" East, a distance of 40.00 feet to the principal place of beginning of land herein described.

Thence South 0° 20' 35" East, parallel to and 40.00 feet Easterly from (by rectangular measurement) the centerline of State Route 301, a distance of 200.00 feet to a point in the Northerly line of Union Station Subdivision No. 1 as apperas in Plat Volume 54, Pages 26, 27 and 28 of the Lorain County Record of Plats.

Thence in said line, North 89° 12' 58" East, a distance of 560.00 feet to a point at a Southwesterly corner of land conveyed to Seabold Brothers as aforesaid.

Thence in the Westerly line of said Seabold Brothers' land, North 0° 20' 35" West, a distance of 200.00 feet to a point and an angle therein.

Thence in the Southerly line of land conveyed to Seabold Brothers, South 89° 12' 58" West, a distance of 560.00 feet to the principal place of beginning of land herein described.

Containing within said bounds 2.5711 Acres of land.

MAP OF
PROPOSED ANNEXATION TO THE VILLAGE OF LAGRANGE

PART OF ORIGINAL LOT 35 TOWNSHIP OF LAGRANGE • COUNTY OF LORAIN • STATE OF OHIO

SCALE 1"=50' JANUARY, 2000
LAUNDON • SIMON • CAHL & ASSOC. INC.
PROFESSIONAL LAND SURVEYORS
110 MIDDLE AVE. ELYRIA, OHIO 44035

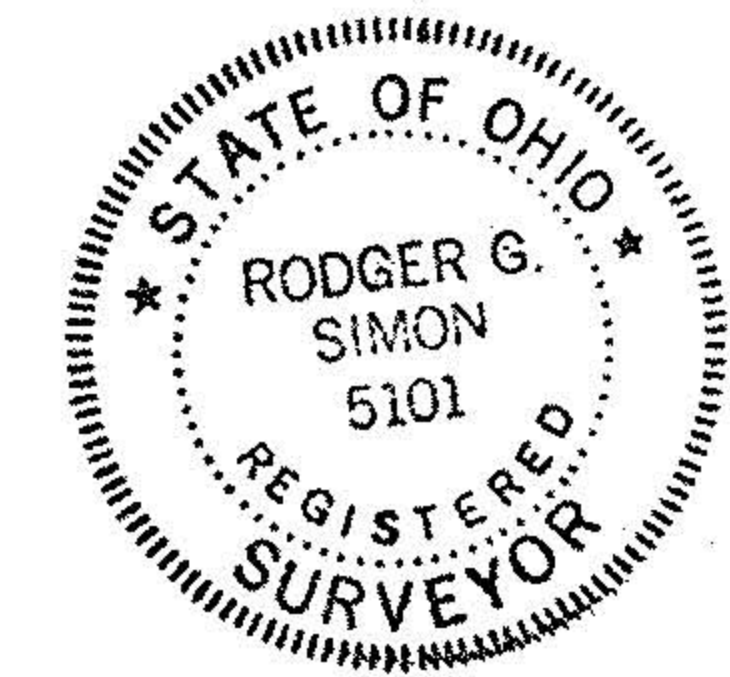

JOB NO. 00-2215