

MAP OF SURVEY

PREPARED FOR
MICHAEL AND KRISTYN MULL

SITUATED IN THE TOWNSHIP OF PITTSFIELD, COUNTY OF LORAIN, STATE OF OHIO AND BEING KNOWN AS PART OF ORIGINAL PITTSFIELD TOWNSHIP LOT 73. ALSO BEING KNOWN AS PART OF THOSE LANDS DEEDED TO THE J.D.L. FARMS IN DEED VOLUME 1265, PAGE 529 PARCEL #4 OF LORAIN COUNTY DEED RECORDS.

SURVEYOR'S STATEMENT

DISTANCES ARE EXPRESSED IN FEET AND DECIMAL PARTS THEREOF. BEARING ARE TO AN ASSUMED MERIDIAN AND ARE USED TO INDICATE ANGLES ONLY. PERMANENT MONUMENTS WERE FOUND OR SET AS INDICATED HEREON. —●— I.P.S. INDICATES A 5/8" IRON PIN WITH IDENTIFICATION CAP SET. —●— M.N.S. INDICATES A MAGNETIC NAIL SET. ALL OF WHICH I DECLARE TO BE CORRECT TO THE BEST OF MY ABILITY AND BELIEF.

Thomas M. Snezek
THOMAS M. SNEZEK, R.L.S. #7051

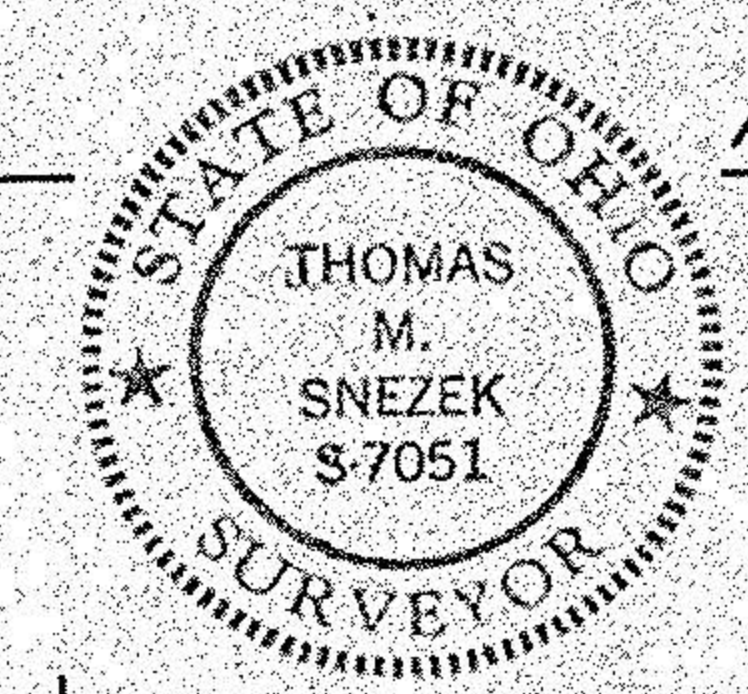

10.30.03
DATE

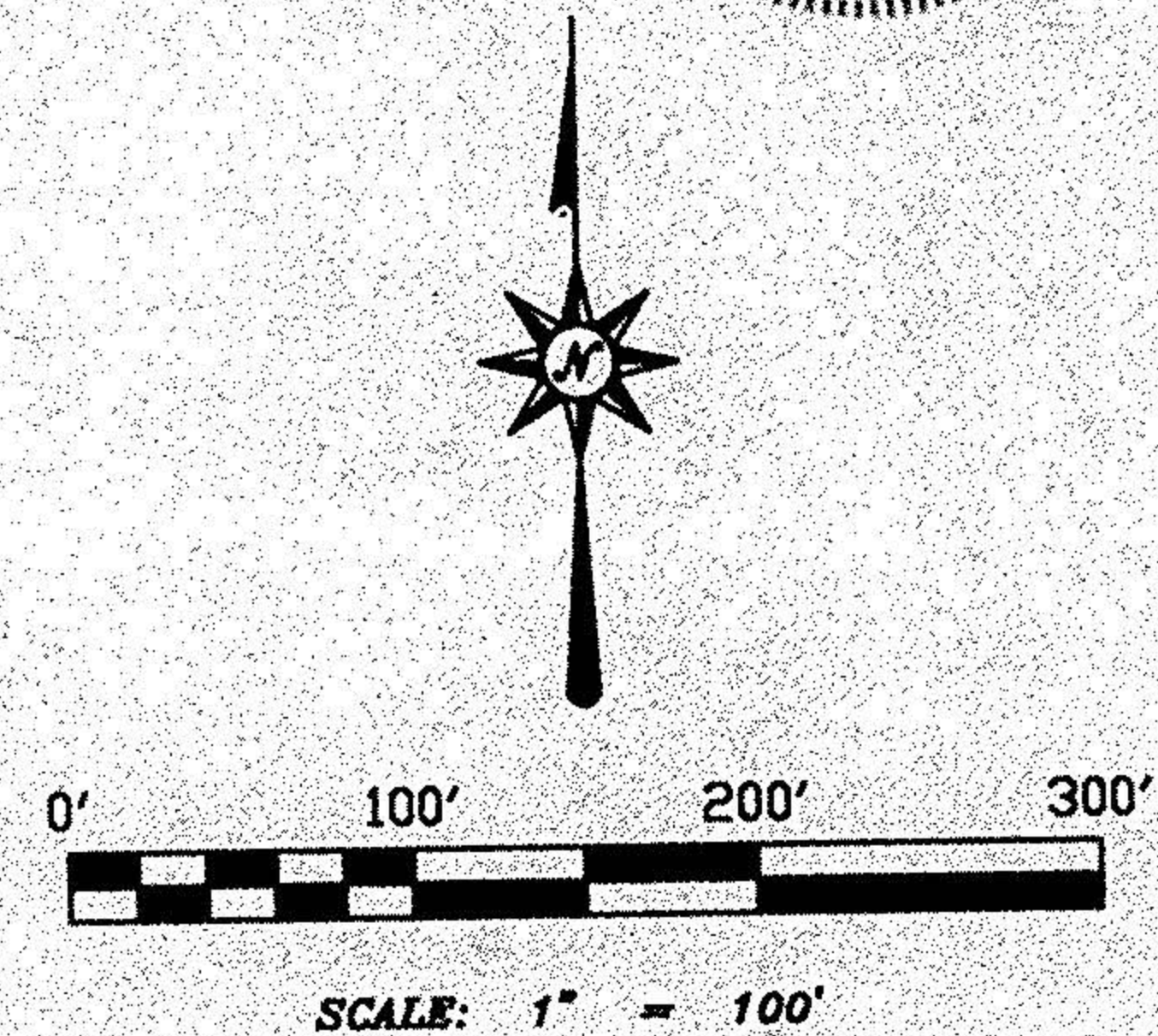

-017
J. D. L. MULL FARMS
P. P. #14-00-073-000-008
VOL. 1265 PG. 529
(REMAINDER ACREAGE = 35.76)

-016
NEW PARCEL "A"
20.0133 ACRES

LAKE SHORE RAILROAD
P. P. #14-00-073-500-001
VOL. 426 PG. 645

No 01535
APPROVED
LORAIN CO.
MAP DEPT.
DATE 12-5-03
PAGE 14-00-073-A
BY R. MAINES
VOID AFTER 03-01-03

