

PARENT PARCEL: 03-00-038-110-032

CHILD PARCEL: 03-00-038-110-057, -058

STARTING POINT: CENTERLINE OF RICHELIEU AVE. & SIDELINE OF ROBINWOOD AVE

NO. 01168

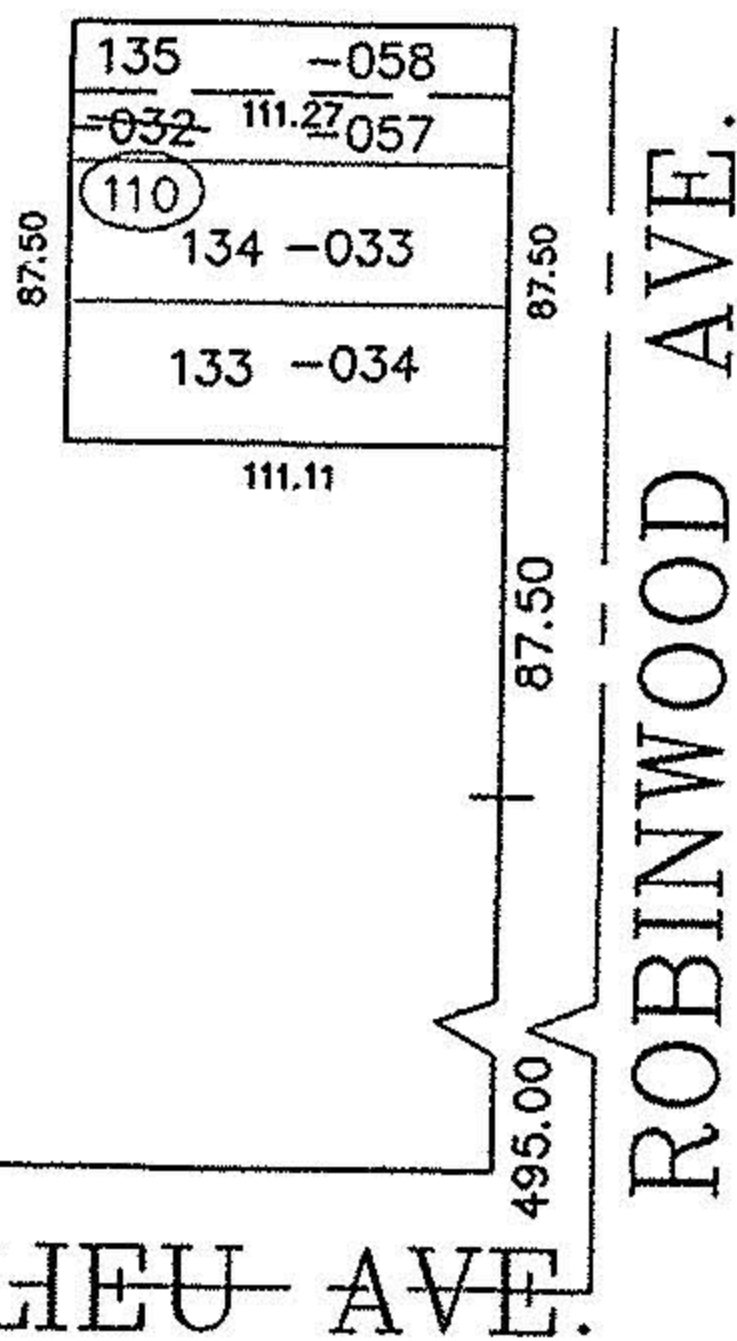
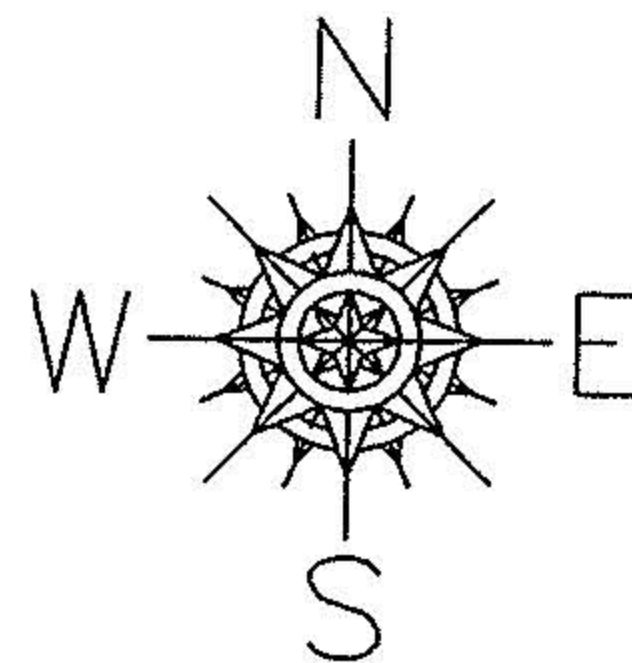

RICHELIEU AVE.

ROBINWOOD AVE.

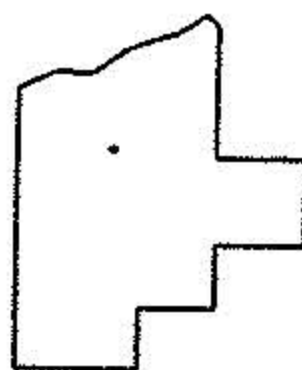

SPLITS/DEEDS PROCESSED

LORAIN COUNTY TAX MAP DEPARTMENT  
226 MIDDLE AVE. ELYRIA, OHIO

SURVEYED BY: STUART W. SAYLER

CLOSURE: 0.00 : 10.000

MAP PAGE(S): 03-00-038-A

APPROVED BY: JAH DATE: 8-1-02

SCALE: 1" = 100 PRIOR INSTRUMENT: 980539298