

ZWICK ASSOCIATES, INC.
 ENGINEERS • SURVEYORS • PLANNERS
 8750 Stearns Road
 Olmsted Township, Ohio 44138-1743
 Tel: (440) 235-2729
 Fax: (440) 235-0604

JOB DAVID & JULIE RODRIGUEZ
 SHEET NO. 1 OF 1
 CALCULATED BY DEH DATE 3-04-03
 CHECKED BY _____ DATE _____
 SCALE 1" = 30'

MILLS CREEK SUBDIVISION SECTION "D" VOL. 25, PG. 40 PLATS

ADELE STREET 20'

S 89° 51' 00" E 99.02' REC.

PARCEL "A"
 9646 SQ. FT.
 0.2214 AC.

EXISTG. HSE.
 NO 5209

S 88° 51' 00" E 99.00' REC.

PARCEL "B"
 4950 SQ. FT.
 0.1136 AC.

S 88° 51' 00" E 99.00' REC.

LANE 35'

LANE 35'

146.57' REC.

N 01° 09' 00" E

50.00'

460.00' REC.

98.30'

148.30' REC.

W 01° 09' 00" BLDG

50.00' SUB.

S/L 30

S/L 29

S/L 28

S/L 27

S/L 26

S/L 25

S/L 24

S/L 53

S/L 23

30" CONGR. (P.)
 CAP SET

518' & IRON PIN WITH ZWICK

PLAT VOL. 10, PG. 11

CITY OF NORTH RIDGEVILLE
 LORAIN COUNTY OHIO

APPROVED
 LORAIN CO.
 MAP DEPT

DATE 3-18-03

PAGE 700007B

BY J. Holland

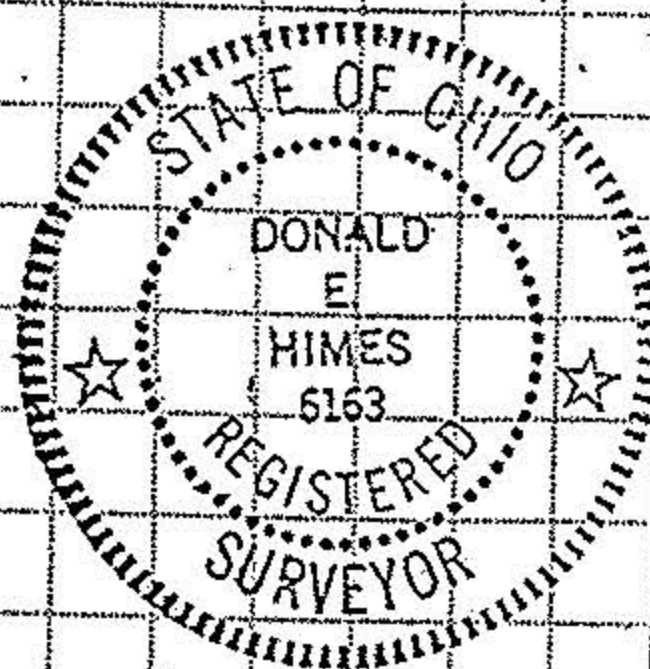

MAY STREET 40'