

TOTAL AREA = 15.76815 ACRES
 TAKE AREA = 15.76815 ACRES
 REMAINDER = 0.00000 ACRES

THEODORE JURCZYNSKI
 VOL 568 PG 367

LORAIN COUNTY
 METROPOLITAN PARKS

Δ.L. 19 BRACE TRACT
 Δ.L. 20 BRACE TRACT

S 89° 08' 32" E
 490.00' R & Δ

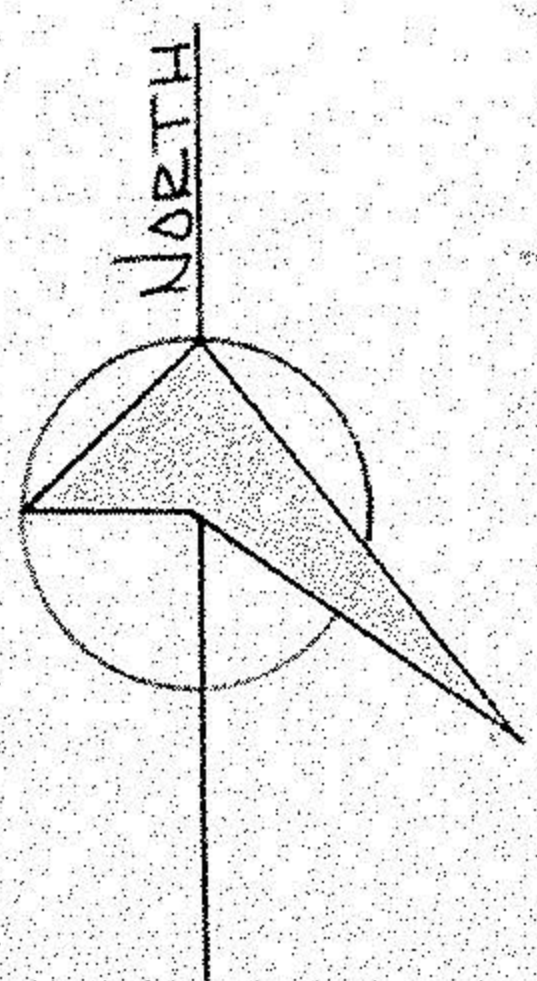

LORAIN COUNTY
 METROPOLITAN PARK DISTRICT

FORD ROAD
 60'
 1080.62 OBS.
 790.90 USED 1 MEAS.
 N 13° 31' 28" E

06-23-020-000-006

6-31

JACK JOSEPH
 VOL 862 PG. 660, 661

AREA IN Δ.L. 20 = 14.00248 ACRES
 AREA IN Δ.L. 21 = 1.76567 ACRES
 TOTAL TAKE AREA = 15.76815 ACRES

TOTAL AREA = 21.47186 ACRES
 TAKE AREA = 21.47186 ACRES
 REMAINDER = 0.00000 ACRES

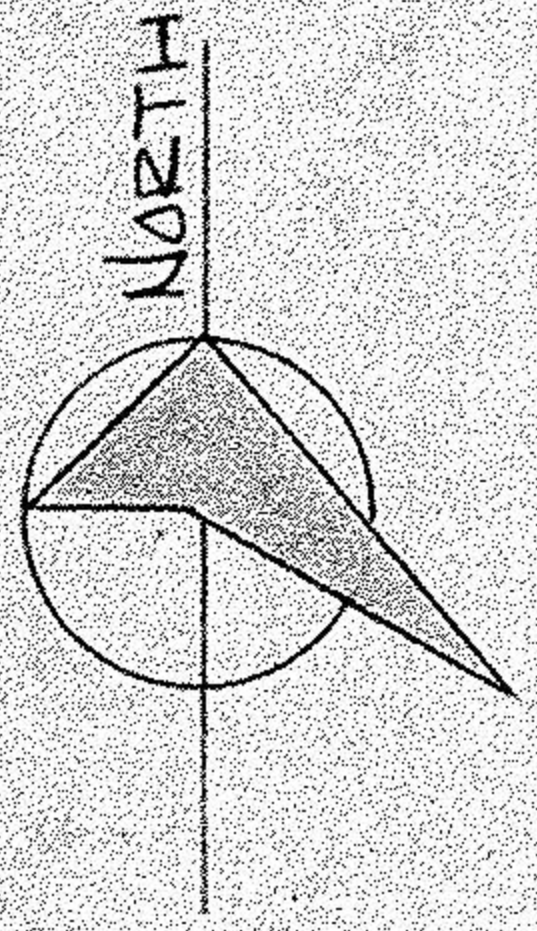

LORAIN COUNTY
 METROPOLITAN PARK DISTRICT

JACK JOSEPH
 VOL 862 PGS 660, 661

Δ.L. 20 BRACE TRACT
 Δ.L. 21 BRACE TRACT

S 88° 56' 45" E
 312.75' OBS.
 395.75' R

FORD ROAD
 60'
 735.52 OBS.
 N 37° 33' 15" E

06-23-021-000-012

6-31

AREA IN Δ.L. 20 = 0.18611 ACRES
 AREA IN Δ.L. 21 = 21.28575 ACRES
 TOTAL TAKE AREA = 21.47186 ACRES

JOHN TERRY - SPRING VALLEY ENT.
 VOL 689 PG. 640, 641

ELLEN MENZIES
 VOL 937 PG. 503
 187.03
 N 17° 33' 15" E

Δ.L. 21 BRACE TRACT
 Δ.L. 174 WEST OF RIVER

909.03' M
 974.03' OBS. N 88° 33' 22" W

BLACK RIVER

LORAIN COUNTY
 METROPOLITAN PARK DISTRICT
 VOL 952 PG. 683

---○---
 ---●---
 ---R---
 ---M---
 ---ΔBS---

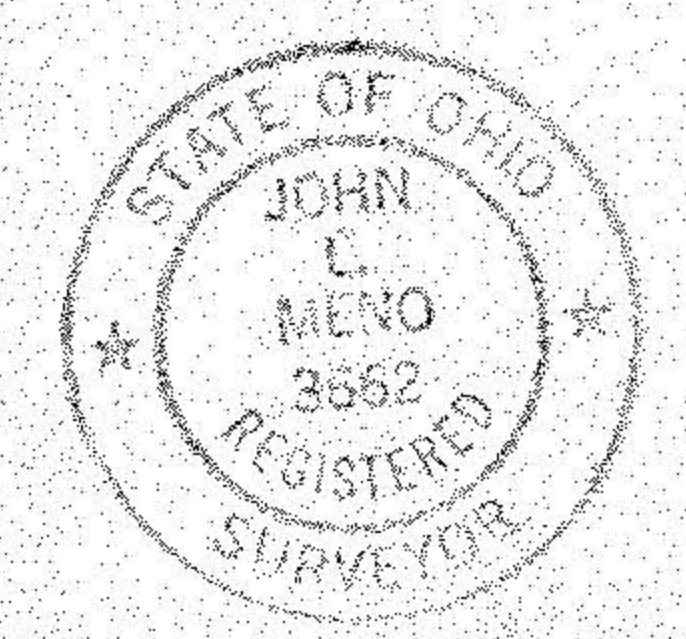

1-20-73
 1" = 100'
 LD BOOK 219 PGS 100-105
 DRAWN BY JFR
 CHECKED BY J.L.M.
 FILE NO. 6-BRACE-20,21

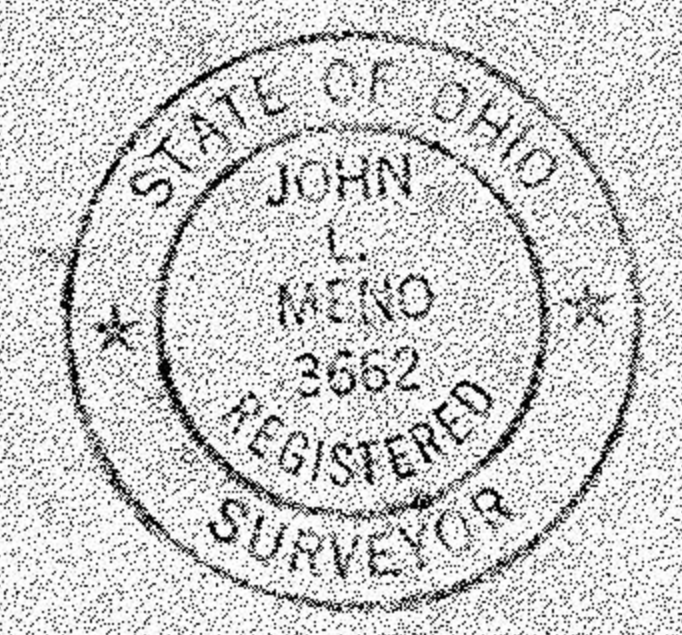

LORAIN COUNTY METROPOLITAN PARKS
 LAND ACQUISITION SURVEY
 JOHN TERRY - SPRING VALLEY
 ELYRIA TOWNSHIP

SCHAFFER, HURA & ASSOCIATES, INC.
 ENGINEERS AND SURVEYORS
 4370 OBERLIN AVE.
 LORAIN, OHIO

NBR
 57

ORIGINAL LOT 20 & 21 BRACE DATE 1-30-
 TOWNSHIP ELYRIA SCALE 1" = 100'
 CITY OF FIELD BOOK 219 PGS 100-105
 COUNTY OF LORAIN DRAWN BY JFR
 STATE OF OHIO CHECKED BY J.L.M.
 W. O. 1685-37 FILE NO. 6-BRACE-21