

Station 164+62.19

- Iron pins fd
 - Iron pins set
 - Monument Boxes
- Lorain County Engineer's
Field Book 156 Pg 34

No 01392
APPROVED LORAIN CO. MAP DEPT
DATE 6-23-03
PAGE 7-00-013-D
BY J Hatfield
03-01392

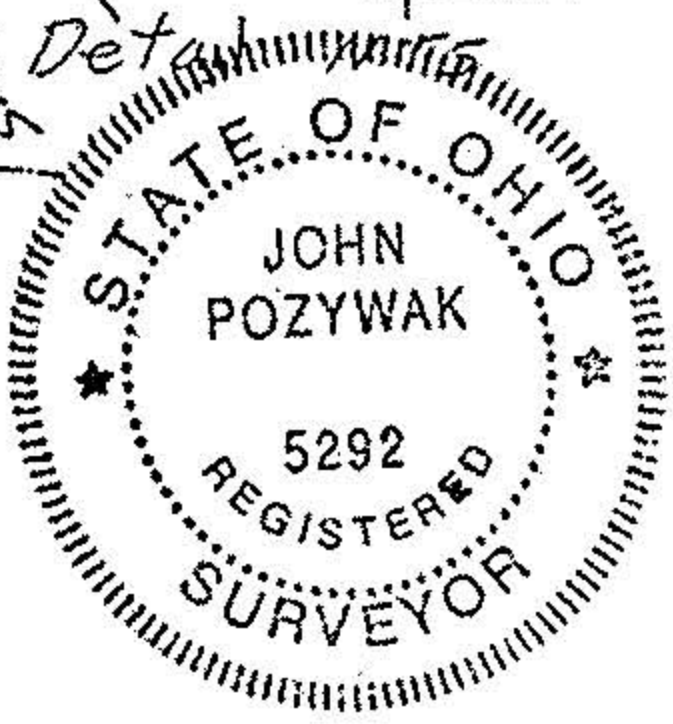

Survey of a Parcel Split
for Monica Kucera
Original Ridgeville Township Lot 13
Lorain County Ohio
Scale 1"=200' October 2002
John Pozywak Revid May 2003

