

PARENT PARCEL: 18-00-003-000-021, 18-00-004-000-009

CHILD PARCEL:

STARTING POINT: CL OF MEDINA - NORWALK RD. & CL OF WEST RD.

NO. 22579-X

MEDINA - NORWALK RD.
P.K. NAIL
R=5729.62'
L=216.88'

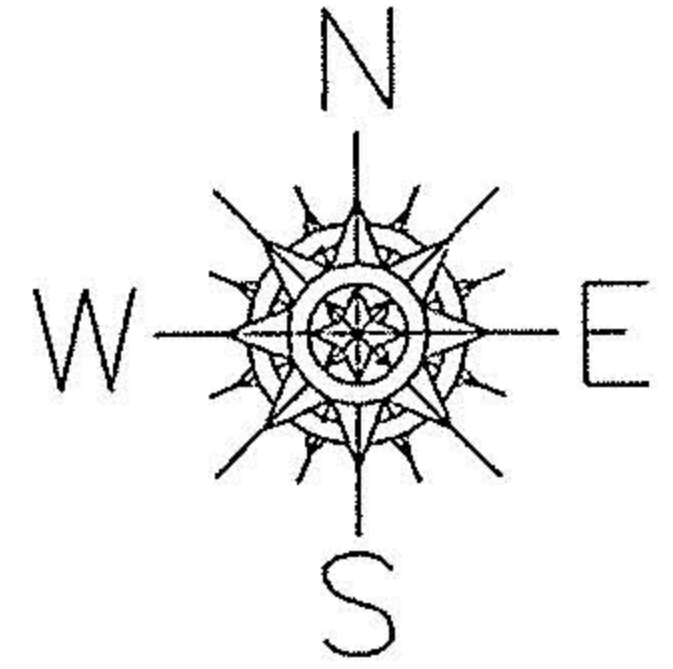

O.L. 4
O.L. 3

286.99'

312.41'

RD.

N00°05'20"E

HAG. NAIL

AC. CORR.

-009

-021

AC. CORRECTION PER SURV.
THOMAS SNEZEK

214.60'

N00°05'20"E

170.00'

170.00'

WEST

HAG. NAIL

-021

1.26 A.

0.84 A.

214.60'

203.08

-017

1.00 A.

203.08

214.60'

S88°20'55"W

PRIOR INSTRUMENT: DV 373/75
DV 1284/249
OR 897/883
OR 877/57

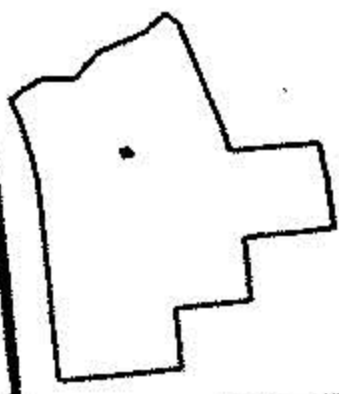

SPLITS/DEEDS PROCESSED
LORAIN COUNTY TAX MAP DEPARTMENT
226 MIDDLE AVE. ELYRIA, OHIO

SURVEYED BY: THOMAS M. SNEZEK June '98
CLOSURE: 0.06 : 10.000
MAP PAGE(S): 18-H
APPROVED BY: TJS DATE: 06/25/98
SCALE: 1" = 100'