

Note: Iron pins found or set shown thus: ●

PLAT OF SURVEY FOR
CHESTER D. & ELIZABETH A. HENRY
SECTION 6 CARLISLE TWP.
LORAIN COUNTY - OHIO
SCALE: 1"=50' APRIL 6, 1937
C. E. Penfound Reg. Surveyor

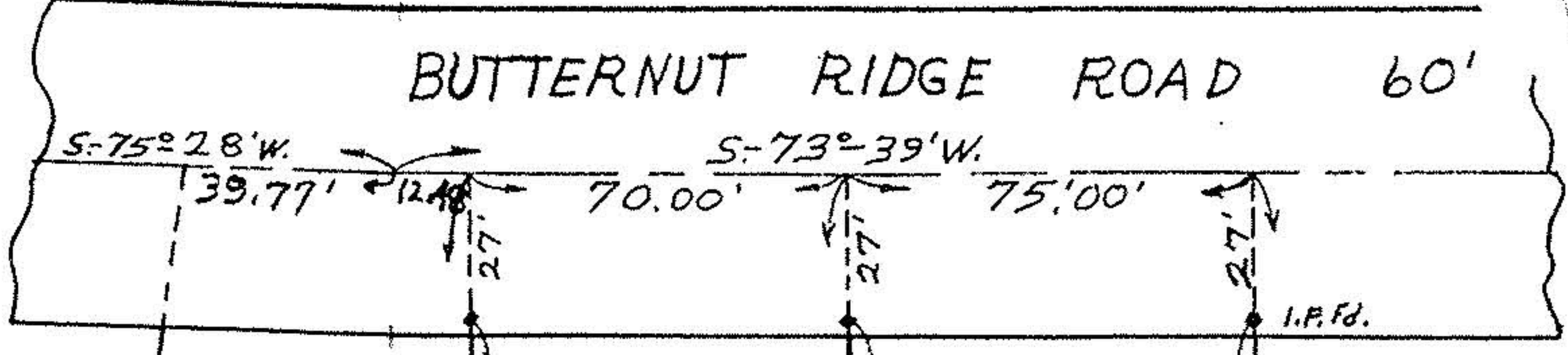

Lawrence O. & Mabel I. Jaycox
D. Vol. 564 Pg. 535

Parcel #2
0.5288 Ac.

Parcel #1
0.4969 Ac.

Paul C. & Elsie W. Leidheiser
D. Vol. 661 Pg. 175
(formerly Charles E. Smith
D. Vol. 295 Pg. 22 Aug. 25, 1938)

