

ZWICK ASSOCIATES, INC.
 ENGINEERS • SURVEYORS • PLANNERS
 8750 Stearns Road
 Olmsted Township, Ohio 44138-1743
 Tel: (440) 235-2729
 Fax: (440) 235-0604

JOB DAVID & JULIE RODRIGUEZ
 SHEET NO. 1 OF 1
 CALCULATED BY DEH DATE 3-04-03
 CHECKED BY _____ DATE _____
 SCALE 1" = 30'

MILLS CREEK SUBDIVISION SECTION "D" VOL. 25, PG. 40 PLATS

ADELE STREET 20'

LANE 35'

REWARD

S 89° 51' 00" E 99.02' REC.

PARCEL "A"
 9046 SQ. FT.
 0.2214 AC.

EXSTG. HSE.
 N# 5209

S 88° 51' 00" E 99.00' REC.

PARCEL "B"
 4950 SQ. FT.
 0.1136 AC.

S 88° 51' 00" E 99.00' REC.

5518' WITH IRON PIN, ZWICK

30" CAP (D.N.G. (P.) SET

30

29

28

27

26

25

24

23

53

RIDGEVILLE

HEIGHTS SUB. 50.00'

148.30' REC.

98.30'

50.00' SUB.

41° 09' 00" W

PLAT VOL. 10, PG. 11

CITY OF NORTH RIDGEVILLE
 LORAIN COUNTY OHIO

APPROVED
 LORAIN CO.
 MAP DEPT
 DATE 3-18-03
 PAGE 700-007B
 BY J. Holland
 1001331

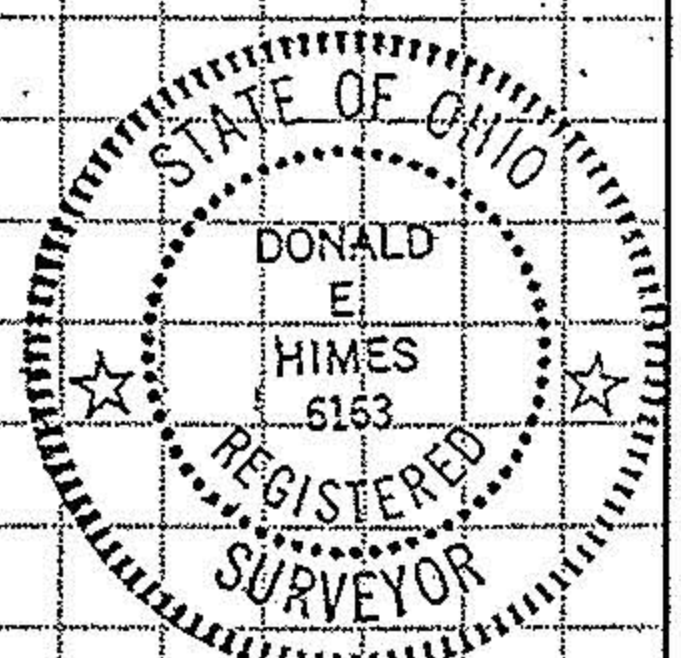

MAY STREET 40'