

SEC. 19  
SEC. 20

WALKER RD.

No 01390

APPROVED  
LORAIN CO.  
MAP DEPT

DATE ~~0002-6-12-03~~

PAGE 4-00-029-A

BY JHATfield

#03-01390

**CURVE DATA**

(A1) R=850.00 L=17.17 C=17.17 D=1°09'26" N75°09'43"W T=8.58	(A2) R=995.00 L=55.68 C=55.67 D=3°12'22" N76°11'11"W T=27.85	(A3) R=605.00 L=18.41 C=18.41 D=1°44'36" N75°27'18"W T=9.20
(A4) R=750.00 L=56.81 C=56.80 D=4°20'24" N76°45'12"W T=28.42	(B1) R=605.00 L=73.11 C=73.06 D=6°55'24" N79°47'18"W T=36.60	(B2) R=750.00 L=72.72 C=72.69 D=5°33'18" N81°42'03"W T=36.39

SURVEY  
OF  
0.4891 ACRES  
BEING ALL OF SUBLOTS 5, 6 & 7  
IN THE  
PINE MEADOWS SUBDIVISION NO. 1  
RECORDED IN VOLUME 74, PAGE 32 & 33  
PART OF  
ORIGINAL AVON TOWNSHIP SECTION NO. 29  
NOW IN THE CITY OF AVON LAKE  
LORAIN COUNTY, OHIO  
FOR CURRANT VILLAGE LLC

BY  
THE HENRY G. REITZ ENGINEERING CO  
4214 ROCKY RIVER DR., CLEVELAND OHIO 44135  
PH. (216) 251-3033 - FAX (216) 251-5149

VICE PRESIDENT  
BY: JAMES T. SAYLER, REG. SURVEYOR NO. S-7425  
SCALE: 1"=50'  
MARCH, 2003

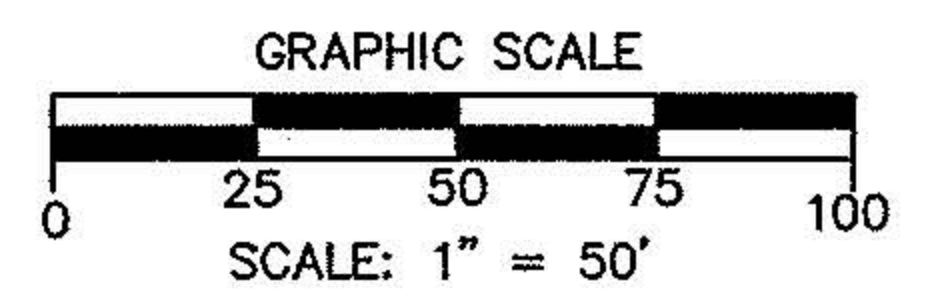
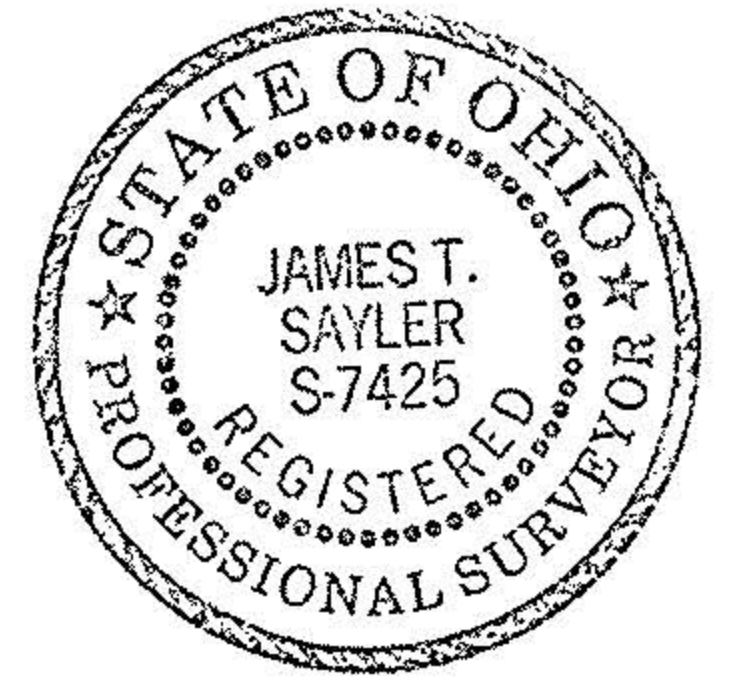

**LEGEND**

- DENOTES 5/8" CAPPED (REITZ ENG) IRON PIN FOUND (UNLESS NOTED OTHERWISE)
- DENOTES 5/8" CAPPED (REITZ ENG) IRON PIN SET
- Ⓜ DENOTES 5/8" IRON PIN IN MON. BOX FOUND & USED

