

GORE-ORPHANAGE RD.

BATES RD.

M.B./I.P. Used

O.L. 2

O.L. 3

-005

PCL. No 1
28.5092 Ac. ±

-004
PCL. No 2
1.9580 Ac. ±

PCL. No 3
5.0000 Ac. ±

O.L. 3

O.L. 18



#22419
APPROVED
LORAIN CO.
MAP DEPT
DATE 1/28/98
PAGE 13-B
BY K. Colburn

SURVEY FOR THE
SETECH FAMILY TRUST
PART of O.L. 3 TRACT 11 CAMDEN TWP.
COUNTY of LORAIN STATE of OHIO
SCALE 1" = 100' JUNE, 1997
BY
LAUNOON • SIMON • CAHL & ASSOC.
PROFESSIONAL LAND SURVEYORS

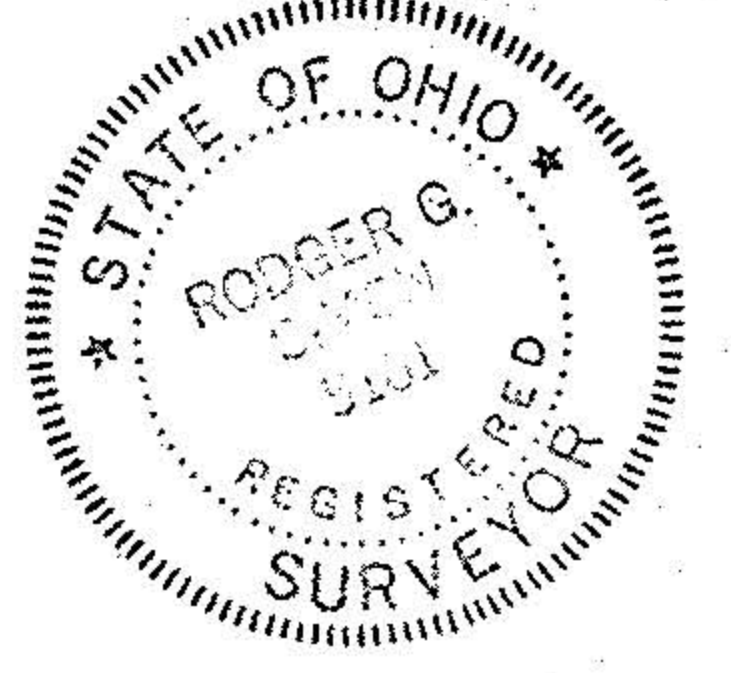

O.L. 19