

SURVEY & LOT SPLIT FOR
RUSSELL NABAKOWSKI & RUDY YUHASZ

Part of Original Lot 6, Brownhelm Township, City of Vermilion, Lorain County, Ohio

February 1, 2003 Scale: 1" = 40'

P.A. Rosebeck & Associates - Registered Surveyor - 705 Willow Creek Dr., Amherst, OH 44001

Phone & Fax: 440-988-4657

#01563

APPROVED
LORAIN CO.
MAP DEPT.
DATE 1-8-04
PAGE 1-00-006A
BY R. MAINES
VOID
AFTER 03-DIS63

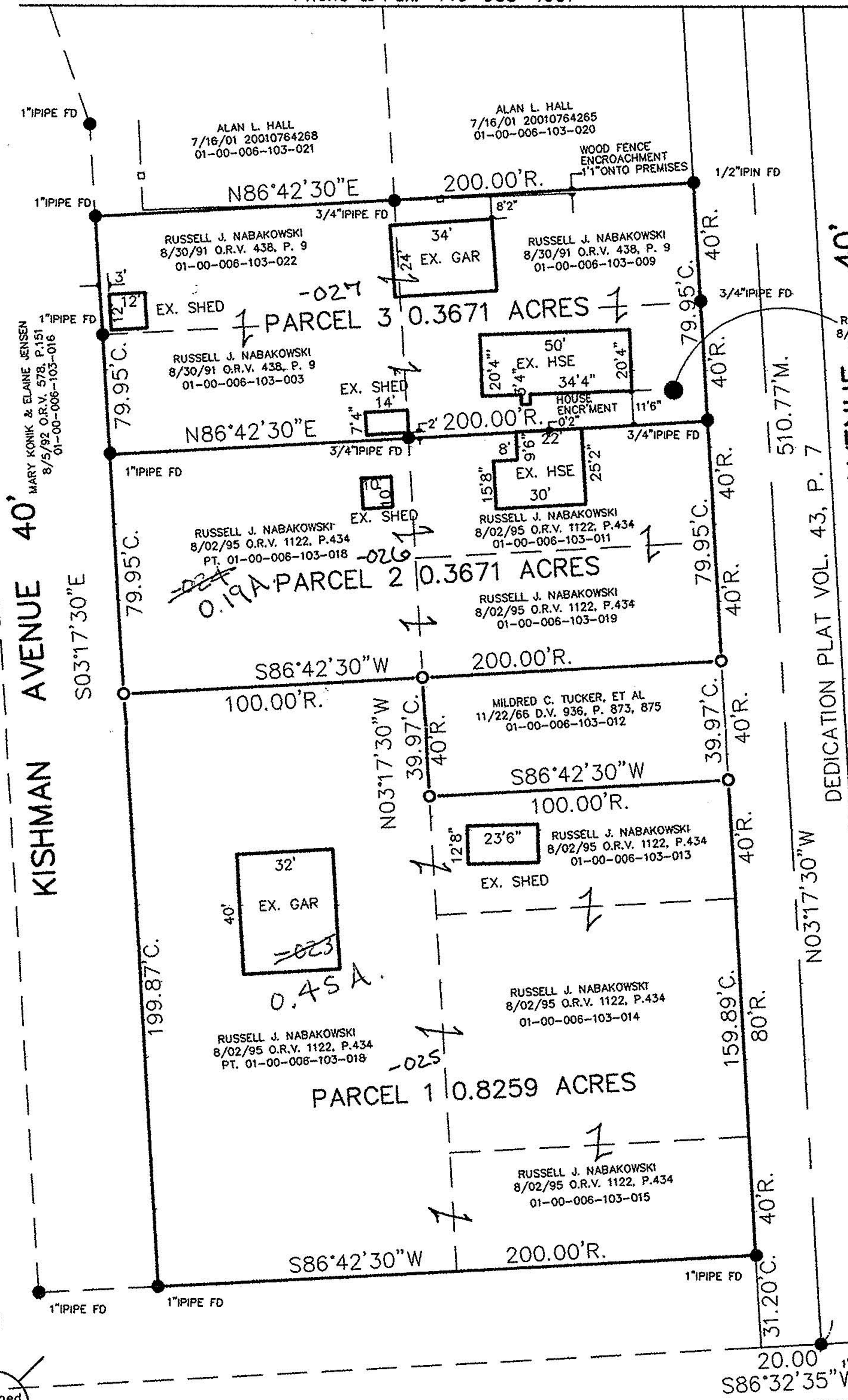

MARY KONIK & ELAINE JENSEN
8/5/92 O.R.V. 578, P.149
01-00-006-103-032

MARY KONIK & ELAINE JENSEN
8/5/92 O.R.V. 578, P.151
01-00-006-103-016

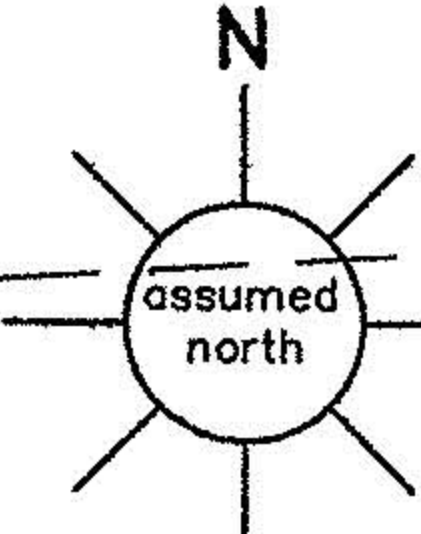

- LEGEND
- IRON PIN FOUND
 - IRON PIN SET



LOT 6, BROWNHELM TWP.,
LORAIN COUNTY, OHIO
file name:
yuhasz/nabakowski

I hereby certify the within to be a true representation of a survey
made by me on February 14, 2003.
Rudy Yuhasz
Registered Surveyor No. 6696