



SCALE: 1"=50'

S 00°09' W 638.25'

- 048
1.999 AC.

S 89°51' E 146.35'

N 00°09' E 551.75'

1 P. SET 34.85'

1 P. SET 34.85'

N 59°15'50" W 170.00'
TRINTER ROAD

EDWARD M. & GERALDINE E. NADSDADY
D.V. 897, PAGE 458

MAP OF PROPOSED PARCEL SPLIT

PREPARED FOR EDWARD NADSDADY

PART OF ORIGINAL BROWNHELM TWP. LOT NO. 64
TOWNSHIP OF BROWNHELM, LORAIN COUNTY, OHIO

REF: P.P. No. 01-00-064-000-019

#18812

APPROVED LORAIN CO. MAP DEPT.	
DATE	1-18-90
PAGE	1 - I
BY	CAROLYN FRANCIS
VOID AFTER #	18812

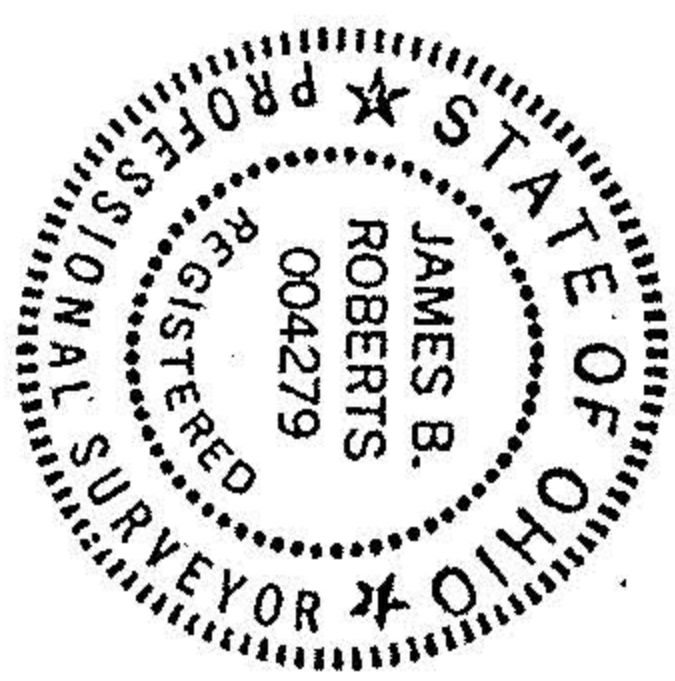

K.E. MCCARTNEY & ASSOCIATES
ENGINEERS - SURVEYORS

ELYRIA, OHIO
DEC. 1989 # 8929265

P.P.N 01-00-064-000-048