

**#22503**  
**APPROVED**  
**LORAIN CO.**  
**MAP DEPT.**  
 DATE \_\_\_\_\_  
 PAGE \_\_\_\_\_  
 BY \_\_\_\_\_  
 VOID AFTER \_\_\_\_\_

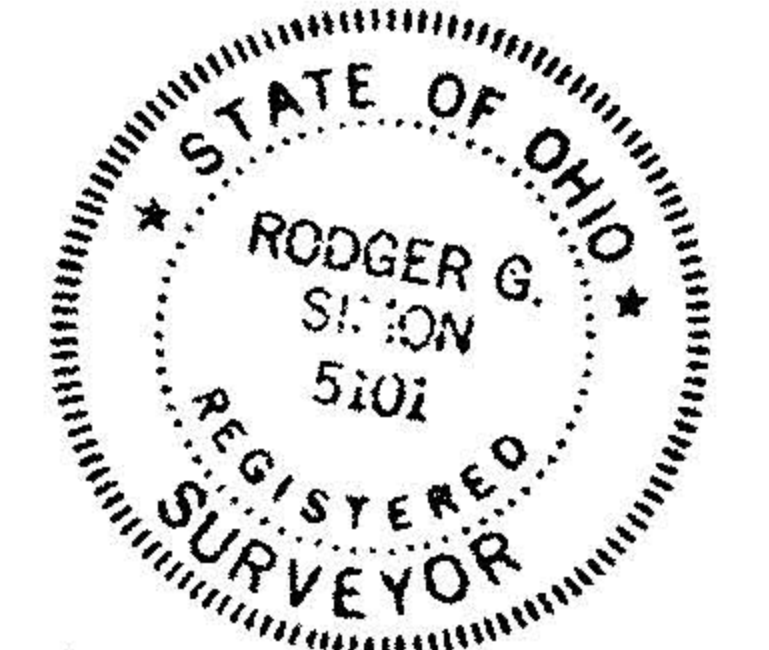

SURVEY FOR  
**TIMOTHY J. & DEBRA K. GRESZLER**  
 and  
**KENNETH J. & CHERYL M. GRESZLER**  
 PART OF O.L. 17 TR. 15 TOWNSHIP of HENRIETTA  
 COUNTY OF LORAIN STATE OF OHIO  
 SCALE 1"=100' AUGUST, 1997  
 BY  
**LAUNDON • SIMON • CAHL & ASSOC.**  
 PROFESSIONAL LAND SURVEYORS  
 JOB NO: 97-2979 F.B. 242 P. 15