

20-05-023-101-001
 RUSSELL MURRAY
 D.V. 1389 P. 328 P.L.#1
 108.038 AC - REC. DEED
 113.10 AC. - T.M.
 106.038 AC ± REM.

034
 2.0000 AC.

			R.P. NO.
DATE	SPLIT NO.	PAGE	
			SURVEYOR

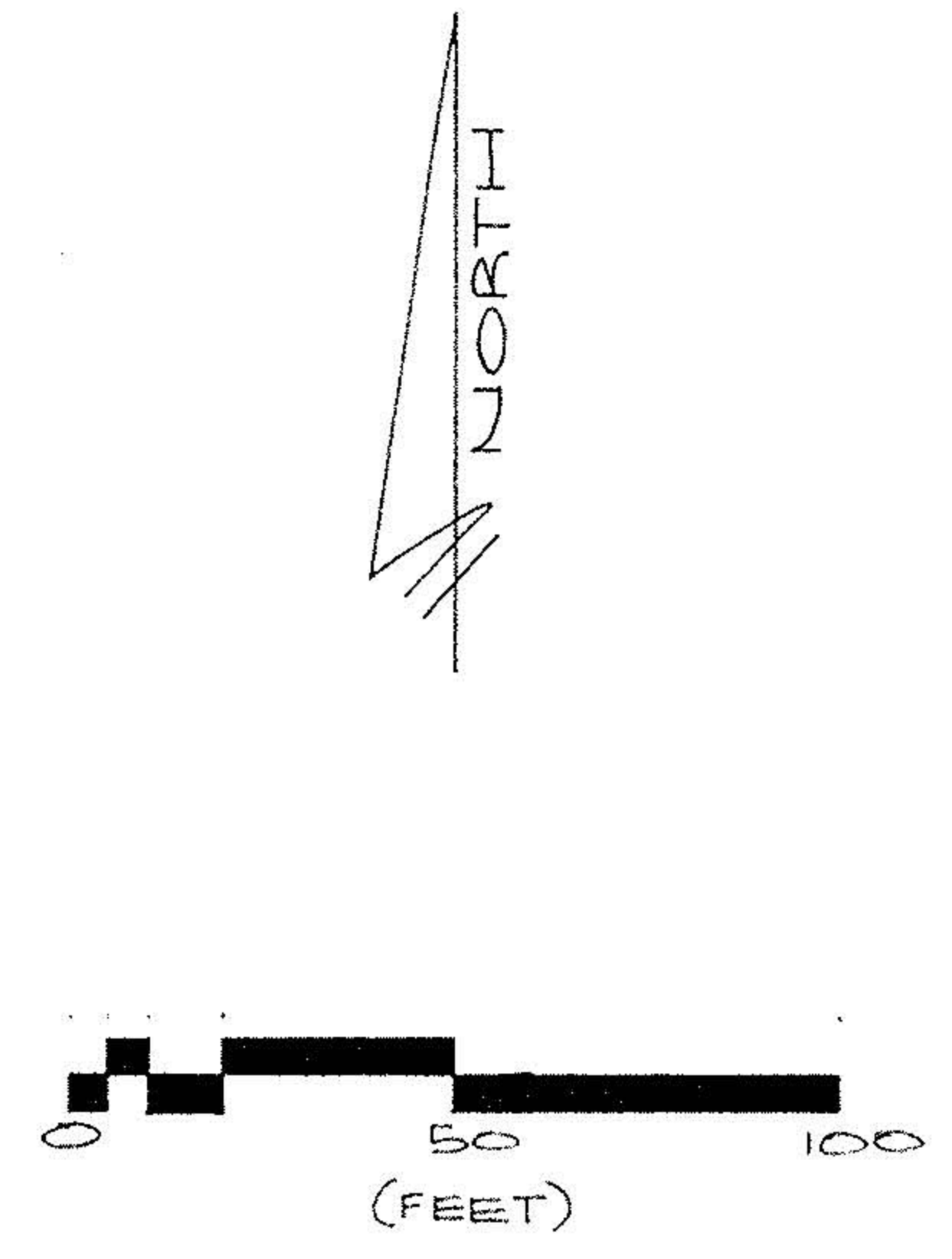

SCALE: 1" = 40'

20447
 APPROVED
 LORAIN CO.
 MAP DEPT.
 DATE 7-16-93
 PAGE 20-05-023
 BY FRANCIS
 VOID AFTER 20447

SURVEY MAP
 PART OF ROCHESTER TOWNSHIP LOT NO. 23
 TRACT NO. 5
 VILLAGE OF ROCHESTER COUNTY OF LORAIN
 STATE OF OHIO
 DATE: APRIL 20, 1993

David L. Elwell
 REG. SURVEYOR NO. 6333

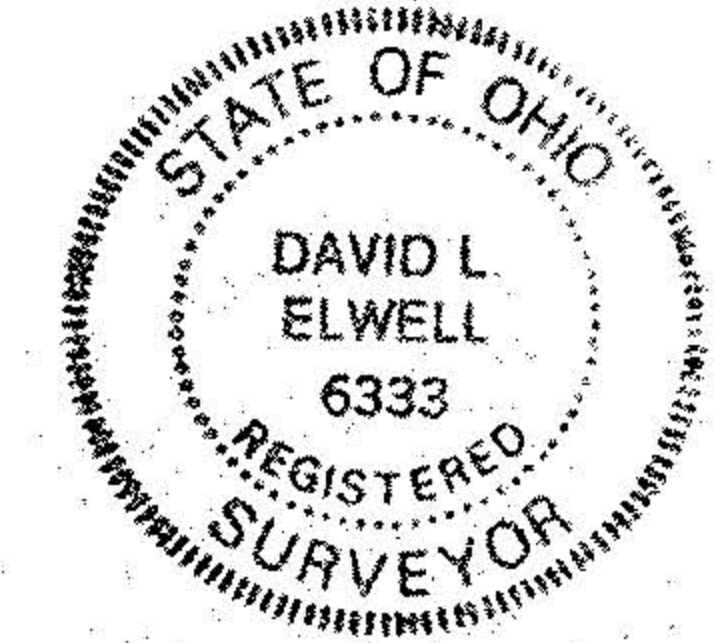

PREPARED BY:
 KS ASSOCIATES INC.
 ENGINEERS • SURVEYORS

PRINTED
 JUL 13 1993
 KS ASSOCIATES, INC.