



LAUNDON • SIMON • CAHL & ASSOC., INC.
CONSULTING ENGINEERS & SURVEYORS
110 MIDDLE AVE., ELYRIA, O. 44035

SURVEY FOR:

DUANE EATON

Orig. Lot 12	City of	Date 2-2-96	Scale 1"=100'
Orig. Sec	Village of	Dwn. by R.G.S	Chkd. by R.C.
Tract 5	County of LORAIN	Job No. 96-2824	F.B. 238/34
Township of ROCHESTER	State of OHIO	Printed	

BEARINGS ARE TO AN ASSUMED MERIDIAN AND USED TO DESCRIBE ANGLES ONLY.

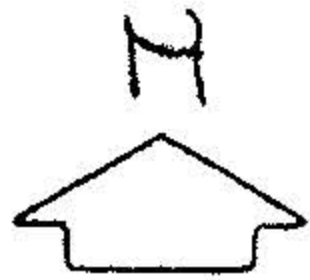

ANDERSON RD. 60'

DUE NORTH

DUE SOUTH

30'

220.00'

30'

310.00'

DUE EAST 315.00'

- 007
1.5909 Ac. to E
1.4394 Ac. to R/W

220.00'

DUE SOUTH

1.P. Set

1.P. Set

RMDR. of -006
25.41 AC. Calc.

HOWARD C. & MARVENE M. EATON
O.R.V. 68 P. 226

21686

APPROVED
LORAIN CO.
MAP DEPT
DATE 3-1-96
PAGE 20 D
BY CAROLYN
FRANCIS
S.W. COR. OF
M.B. W/I.P. USED

GRIGGS RD.

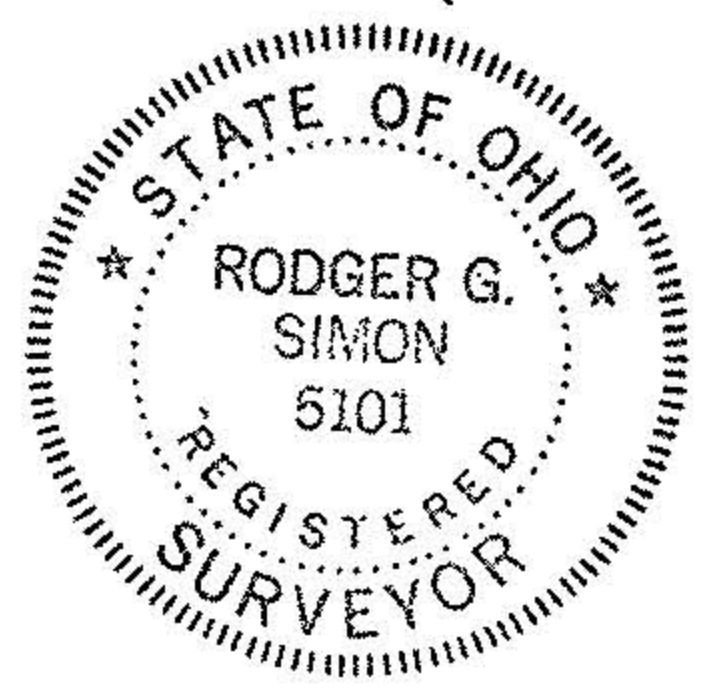

20-05-012-000