

DONALD J. & PAULETTE DUBENA
 D.V. 1164 P. 580
 1.23 AC.

1.000 AC.

WILLIAM F. & MILDRED ROERIG D.V. 1153 P. 574
 40.46 AC.

(P.P. No. 20-04-012-000-014)

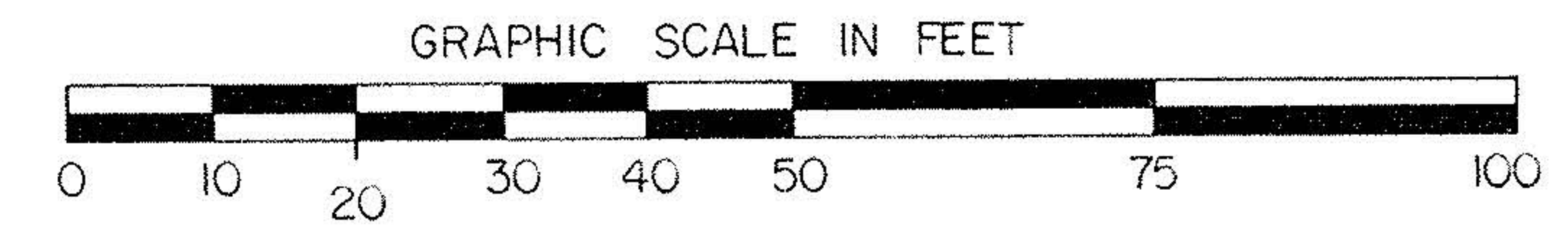
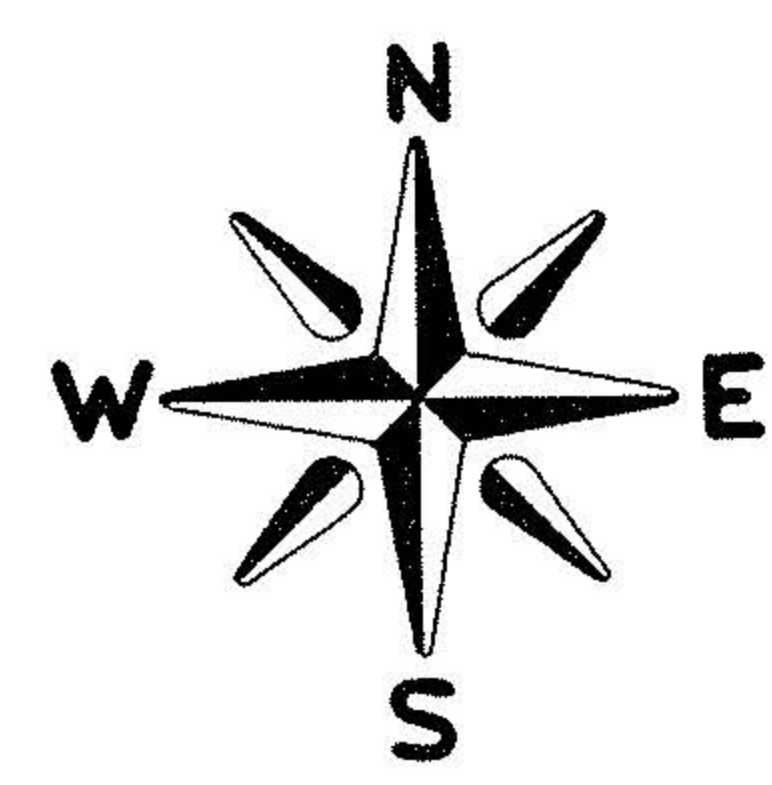

BOUNDARY SURVEY
 PART OF ORIGINAL ROCHESTER TOWNSHIP
 LOT No. 12 TRACT No. 4
 TOWNSHIP OF ROCHESTER COUNTY OF LORAIN
 STATE OF OHIO
 MARCH 27th, 1988 SCALE: 1" = 20'

PREPARED FOR
RON ROERIG

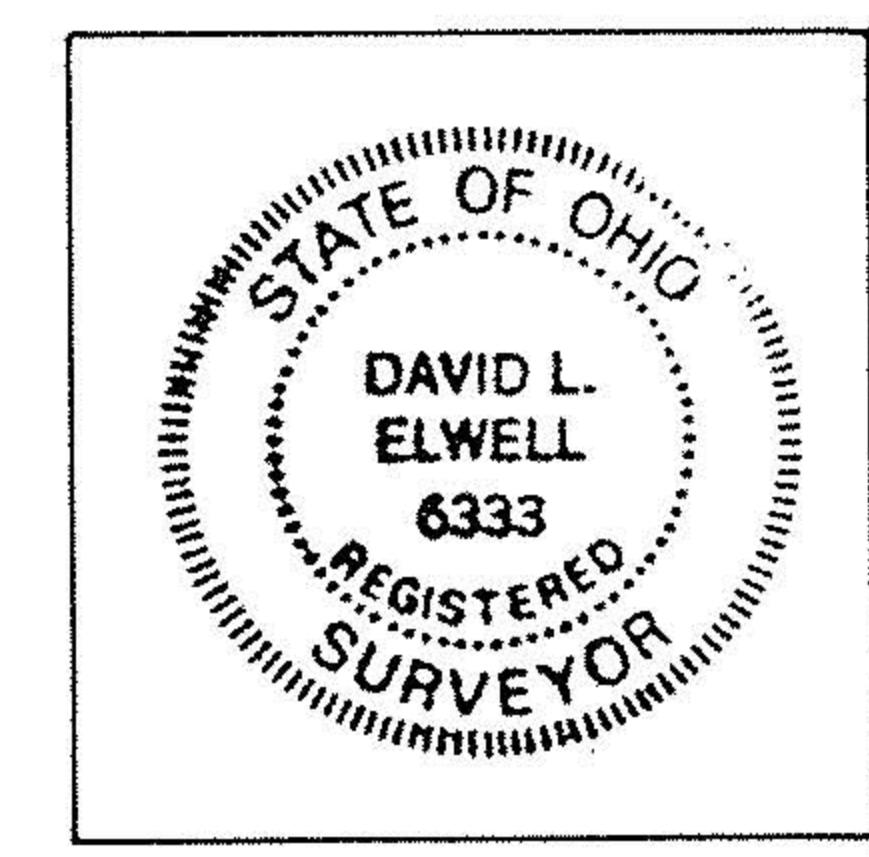

20-04-012-000
David L. Elwell
 DAVID L. ELWELL - REG. SURVEYOR #17910

APPROVED
LORAIN CO.
MAP DEPT.
DATE 4-18-88
PAGE 20-6
BY C. Francis
VOID UNL
AFTER 17910

NOTE: BEARINGS SHOWN ARE ASSUMED AND FOR THE PURPOSE OF DESCRIBING ANGLE