

19-06-118-000
19-06-118-000
19-06-118-000

WEBSTER ROAD 60'

Spk. S-89°45'30"-E Spk. 392.71' Plat & Meas. N-89°44'30"-E 259.95' Plat & Meas. Spk. 193.70' 199.01' 74.10' 185.85' Spk. 30'

#18098

APPROVED
LORAIN CO.
MAP DEPT.
DATE 9-1-88
PAGE 19-06-118-A & B
BY T. McMain
VOID AFTER 18098

042

(3.5882 AC.)

(5.0002 AC.)

(3.4118 AC.)

RICHARD

E.

WANAT

D.V. 1218 P. 828
12.00 AC. Dd.
12.0002 AC. Calc.

SUBLOT NO. 11
NIMROD SQUARE SUB. NO. 1
P.V. 23 218.00' Plat

CHARLES W. & MARY B. STURGILL
D.V. 1193 P. 193
432.86' Dd.

REX & RITA L.
INGOLD
D.V. 1019 P. 497
115.43' Dd.

796.29' Dd. & Used.

796.96'

798.58'

Dd. & Used. 800.87'

N-0°50'15"-E

S-0°28'35"-W

S-0°28'35"-W

S-0°28'35"-W

198.73'

273.10'

185.83'

N-89°33'10"-W

I.P. 657.66' Dd. & Calc. P. 695

MYRON E. & ELINOR A. KOLBE

D.V. 812 P. 695

BOUNDARY SURVEY
OF PART OF
PENFIELD TOWNSHIP
ORIGINAL LOT 118 TRACT 6
TOWNSHIP OF PENFIELD
COUNTY OF LORAIN
STATE OF OHIO



SCALE: 1"=100'

Prepared by
KS ASSOC. INC.
ENGINEERS SURVEYORS
David L. Elwell
REG. SURV. NO. 6333

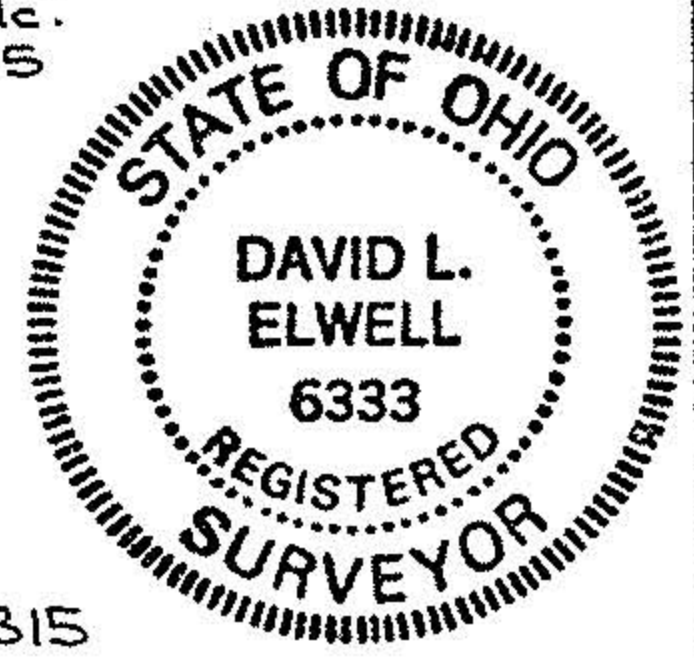

88-315

30'

30'

112'

130'

15' WIDE EASEMENT

186.49'
S-84°43'12"-E

207.50' Plat

SUBLOT NO. 10
NIMROD SQUARE SUB. 1
P.V. 23 P. 9

281.69' Dd.

MICHAEL J. & MARIAN HLUSZTI
D.V. 1371 P. 905

281.68' Dd.

JACKIE L. & FRANCES HEVENER
D.V. 1012 P. 139