

19-06-118-AB #18452 19-06-118-000-

WEBSTER ROAD

ROAD

60'

S-89°45'30"E 193.70' Spk. 392.71' Plat & Meas. N-89°44'30"E 259.95' Plat & Meas. Spk. 185.85' Spk.

SUBLOT NO. 11
NIMROD SQUARE SUB. NO. 1
P.V. 23 218.00' Plat

CHARLES W. & MARY B. STURGILL
D.V. 1193 P. 193
432.86' Dd.

REX & RITA L. INGOLD
D.V. 1019 P. 497
115.43' Dd.

796.29' Dd. & Used.

#18452

APPROVED
LORAIN CO.
MAP DEPT.
DATE 5-25-89
PAGE 19-06-118 B
BY CAROL FRAVENS
VOID AFTER #18452

(3.5882 AC.)

(5.0002 AC.)

(3.4118 AC.)

RICHARD E.
D.V. 1218 P. 828
(3.0478 AC.)

12.00 AC. Dd.
12.0002 AC. Calc.

WANAT
-044
(2.7751 AC.)

046
(0.5404 AC.)

045
(0.6367 AC.)

MYRON E. & ELINOR A. KOLBE
D.V. 812 P. 695

JACKIE L. & FRANCES HEVENER
D.V. 1012 P. 139
281.68' Dd.

MICHAEL J. & MARIAN HLUSZTI
D.V. 1371 P. 905
281.69' Dd.

207.50' Plat
SUBLOT NO. 10
NIMROD SQUARE SUB. 1
P.V. 23 P. 9

BOUNDARY SURVEY
OF PART OF
PENFIELD TOWNSHIP
ORIGINAL LOT 118 TRACT 6
TOWNSHIP OF PENFIELD
COUNTY OF LORAIN
STATE OF OHIO



Prepared by
KS ASSOC. INC.
ENGINEERS SURVEYORS

David L. Elwell
REG. SURV. NO. 6333

SCALE: 1"=100'

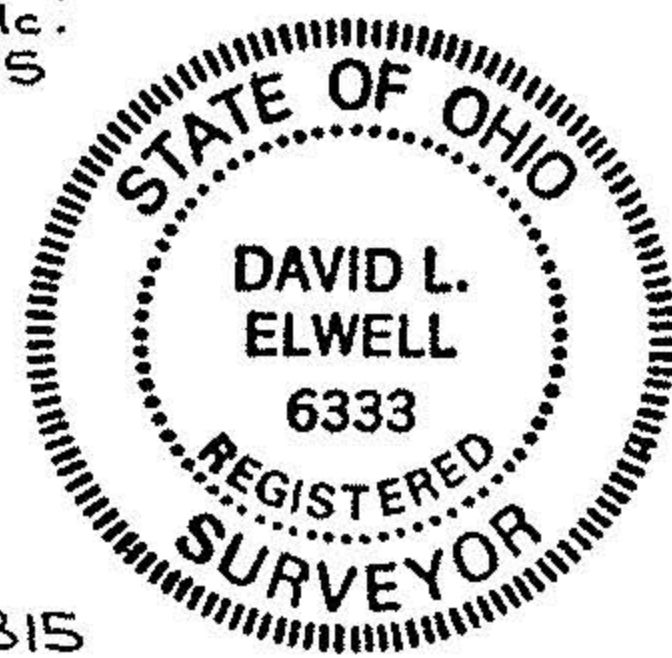

88-315