

DETAIL "A"  
NTS

**BASIS OF BEARINGS**

THE BASIS OF BEARINGS IS THE CENTERLINE OF JONES ROAD BEARING NORTH 89°47'00" WEST BETWEEN MONUMENTS FOUND, PER OFFICIAL RECORD VOLUME 1074 PAGE 786.

**CERTIFICATION**

I HEREBY CERTIFY THAT I HAVE SURVEYED THESE PARCELS OF 3.4359 AND 4.0050 ACRES AND CERTIFY THAT THIS PLAT IS A CORRECT REPRESENTATION OF THE SAME. MONUMENTS HAVE BEEN SET OR FOUND AS SHOWN.

*James D. Wellert*  
JAMES D. WELLERT  
R.L.S. NO. 7545

**ACREAGE SUMMARY**

7.4409 ACRES ORIGINAL AREA  
-4.0050 ACRES (PARCEL B)  
3.4359 ACRES REMAINING (PARCEL A)

**LEGEND**

- 5/8 X 30 INCH REBAR SET A CAP MARKED WELLERT CO'P.
- MONUMENT FOUND AS NOTED

CONSULTANT:

Wellert Corporation  
5136 Beach Road • Medina, Ohio 44256  
t: 330.239.2699 • f: 330.239.0272

| NO. | DATE | REVISION DESCRIPTION |
|-----|------|----------------------|
|     |      |                      |
|     |      |                      |
|     |      |                      |
|     |      |                      |

NORTH

SCALE ( IN FEET )  
1 inch = 100 ft.

PREPARED UNDER THE DIRECT SUPERVISION OF:

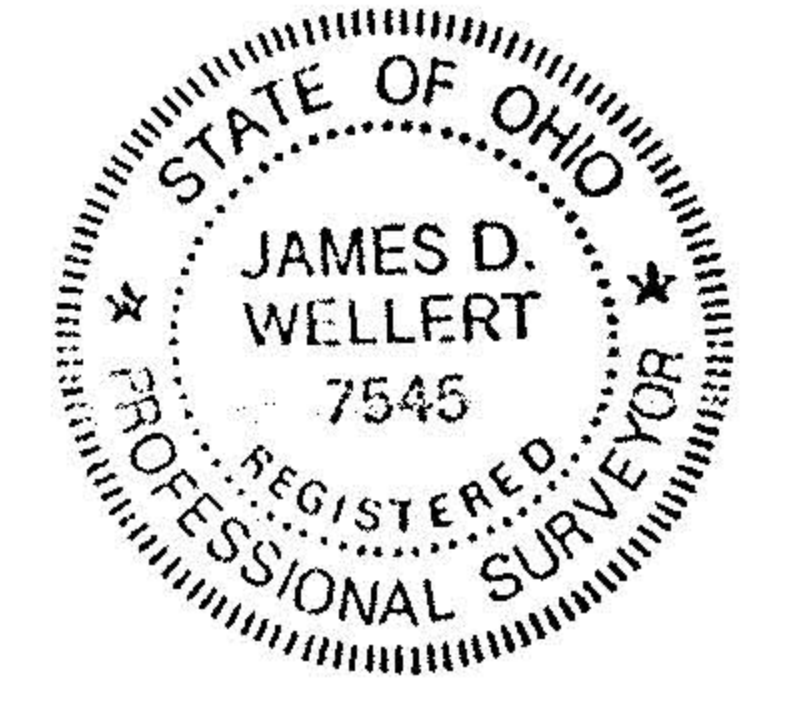

**SITE INFORMATION:**

DIANA SMITH  
39298 JONES ROAD  
LITCHFIELD, OHIO  
44253

SCALE: 1"=100'

DATE: 10/15/2002

DESIGNED BY: JDW

DRAWN BY: JDW

CHECKED BY: GH

FILE NAME: SMITH

JOB NUMBER: 020930

DRAWING TITLE:

LOT SPLIT  
PLAT