

19-01-063 N · 89° 44' 13" · E GARY E. & FAYE HANDROSH

19-01-063

19-01-063

19-H
N.W. CORNER
LOT 63

-00-017

19-H

1070619H

WILLIAM P. & LINDA ALBRECHT

N · 00° 53' 03" · W

1033.06'

6.1577 ACRES

(15)

1030.27'

S · 00° 53' 03" · E

-017

260.00'

S · 89° 07' 20" · W

837.69'

2170.49' N · 89° 07' 20" · E

SOUTH LINE OF
LORAIN COUNTY

S.W. CORNER
LOT 63

SMITH ROAD

NORTH
SCALE · 1" = 200'

SOUTHEAST CORNER LOT 63

N · 00° 06' 49" · W

FOSTER ROAD

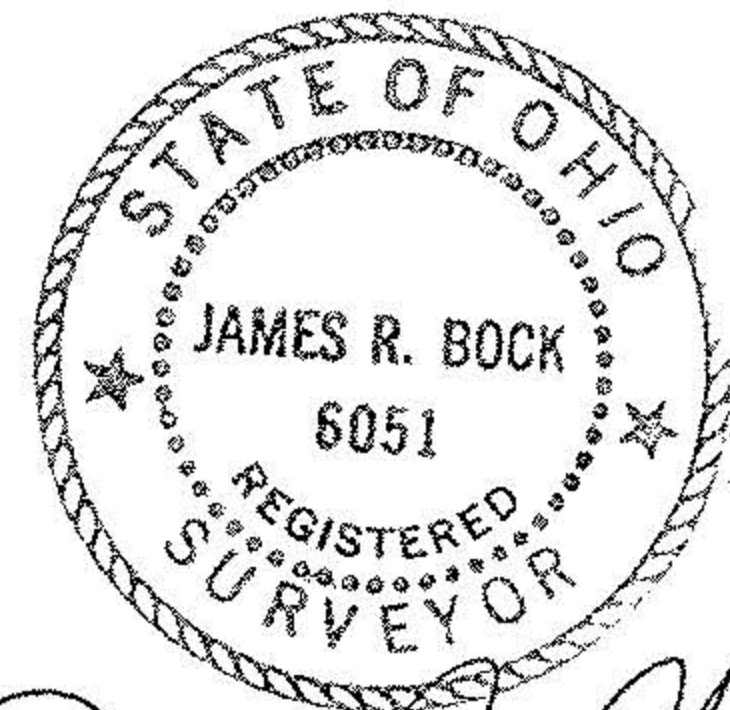

James R. Bock
JAMES R. BOCK P.S.
REG. SURVEYOR No. 6051

CARL M. CLARK P.S.
REG. SURVEYOR No. 6358

- IRON PIN FOUND
- IRON PIN SET
- R.R. SPIKE FOUND
- R.R. SPIKE SET
- ✕ P.K. NAIL FOUND
- ⊠ P.K. NAIL SET
- ▲ ⚡ BREAK POINT FOUND
- △ ⚡ BREAK POINT SET
- ⊞ STONE FOUND
- FENCE POST FOUND & USED

OWNER: THE SPENCER
LAND COMPANY
STATE OF OHIO, LORAIN COUNTY
PENFIELD TOWNSHIP
TRACT 1, LOT 63
DATE: DEC., 1976 PROJECT: 76555-15

BOCK & CLARK INC
ENGINEERING · SURVEYING · LAND DEVELOPMENT RESEARCH
219 E. LIBERTY ST.
MEDINA, OHIO 44256
PHONE · 725-0011