

MEDINA - NORWALK ROAD 18

P.V. 19 P. 13
6.88° 42' 00" E.

P.C. $\phi R = 22,971.85$

$\Delta = 0^\circ 09' 42''$ T = 60.62'
Arc 8; Ch. = 121.28'
5.88° 37' 09" E.

50' R/W LINE BY APPROPRIATION PROCEEDINGS
JAN. 8, 1943 LOR. CO. COMMON PLEAS COURT CASE # 44424

PITTS RO.

-001
HARRY JR. & CAROL LEONARDI
D.V. 1001 P. 211

-023
EDWARD M. KRYSZOWSKI ET AL
O.R.V. 776 P. 766

PCL. N#1
1.7183 Ac. ϕ
1.5419 Ac. R/W

PCL. N#2
6.2834 Ac. ϕ
5.6941 Ac. R/W

#21998
~~21998~~

APPROVED
LORAIN CO.
MAP DEPT.
DATE 11-27-96
PAGE 18-F
BY B. BELL
VOID AFTER #21998

NORFOLK & SOUTHERN R.R.

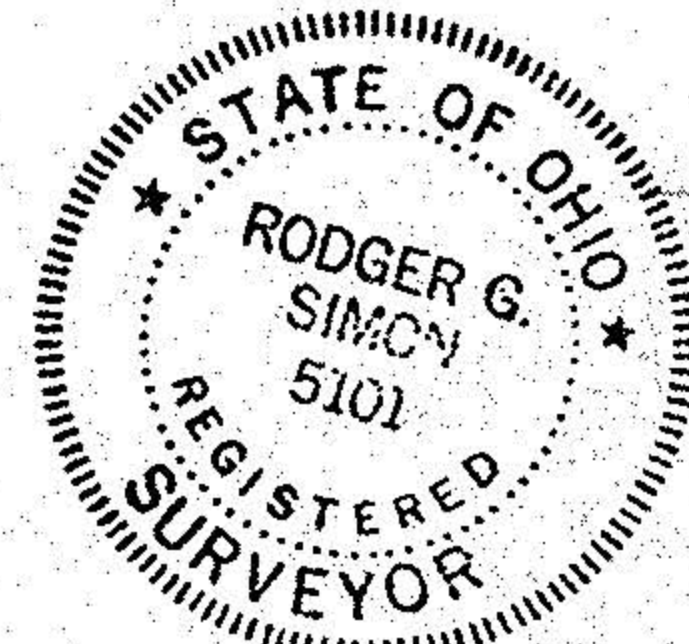

SURVEY FOR
ELIZABETH D. KERT

PART OF O.L. 34 TOWNSHIP OF WELLINGTON
COUNTY OF LORAIN STATE OF OHIO
SCALE 1" = 50' AUG. 1996
LALINDON • SIMON • CAHL & ASSOC.
PROFESSIONAL LAND SURVEYORS
JOB N# 96-2880 FB. 289 P. 68

