

Diedrick Bros

Barbara Jackson
980517686

OL 84 OR 254 Pg 314

OL 83

13.33 Acres
by Deed

Antoinette G
Bockmore
OR 665
Pg 660

OL 97
OL 98

Hawley Rd
N 69° 36' 46" E
971.40

60' R/W

David C
Lynette
Pickworth
OR 892 Pg 81

254.74'

47.47

12,000 Acres

Due South
754.90'

N 88° 4' 44" W

928.26'

Due South
Wayne D & Joni
Pickworth
Vol 1199
Pg 848

Antoinette G Bockmore
OR 665
Pg 660

12.665 Acres

954.40' calc

Existing fence line
OL 103 N 88° 04' 44" W

calc 586.39

fence post

Ruth Aciden
Div 1179
Pg 608

Hawley Rd
586.10

N 20° 33' 16" E

385.76'

(2)

(1)

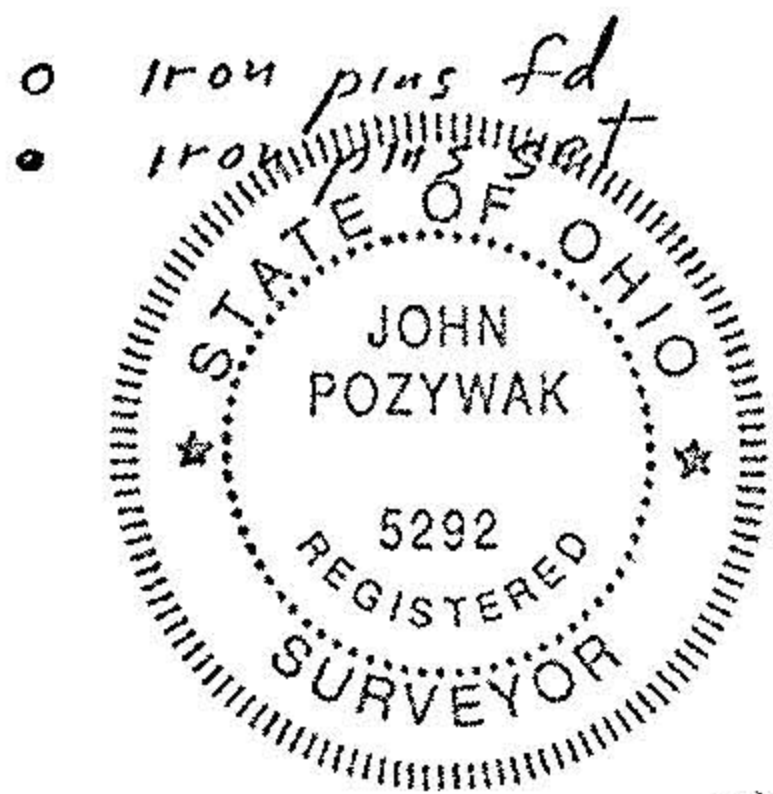

David McConnell &
Lois Bannan
OR 534 Pg 646

John Pozywak
Reg Surveyor
5292

Survey of
Parcel Split for
Mark Kerchmar

Original Lot 98
Pittsfield Township
Lorain County Ohio
Scale 1" = 200 May 1998