

S.H. 58 ASHLAND OBERLIN RD. 60' R/W

N 00°05'20" W

PECK WADSWORTH ROAD 60' R/W

N 90°00'00" E 840.00'

105.00'

30'

99.00'

6.00'

105.00'

WALTER L. & LULA MAE
HARDY

JAMES DESANTO &
NELLIE DESANTO

N 00°05'20" W 209.00'

0.0288 AC.

S 00°05'20" E 209.00'

AGUSTIN J. AVILES

105.00'

99.00'

6.00'

105.00'

S 90°00'00" W

NORTH

SCALE · 1" = 50'

#11768

18-00-020-000-

APPROVED
LORAIN CO.
MAP DEPT.

DATE 6-21-78

PAGE 18-00-020-

BY C. Francis

VOID AFTER 11768

EXHIBIT A

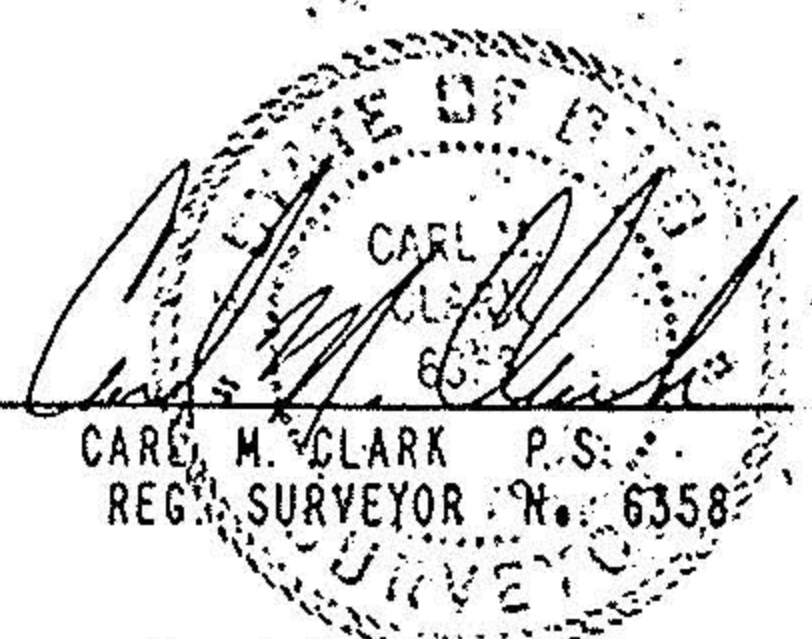

JAMES R. BOCK P.S.
REG. SURVEYOR No. 6051

CARL M. CLARK P.S.
REG. SURVEYOR No. 6358

- IRON PIN FOUND
- IRON PIN SET
- R.R. SPIKE FOUND
- R.R. SPIKE SET
- ✕ P.K. NAIL FOUND
- ⊠ P.K. NAIL SET
- ▲ BREAK POINT FOUND
- △ BREAK POINT SET
- ⊞ STONE FOUND
- FENCE POST FOUND & USED

OWNER: JAMES & NELLIE DE SANTO

STATE OF OHIO, COUNTY OF LORAIN

TOWNSHIP OF WELLINGTON, PART OF

ORIGINAL TWP. LOT 20

DATE: MAY 1978 PROJECT: 76473

219 E. LIBERTY ST.
MEDINA, OHIO 44256
PHONE · 725-0011

BOCK & CLARK INC.

ENGINEERING · SURVEYING · LAND DEVELOPMENT RESEARCH