

GRAFTON EASTERN RD.

MB
FD

80.00 AC. DEED V. 903 P. 636

16-D #15691

CARL D. RAZZANTE JR. ET. AL.
DEED V. 903 P. 636
10.00 AC. DEED

#15691

APPROVED
LORAIN CO.
MAP DEPT.

DATE 7-10-84

PAGE 16-D

BY T. McNeil

VOID
AFTER

533.78' S 1°15' W
COWLEY RD. - 60 FEET WIDE

ORIGINAL LOT 29

740.41' S 89°12'E

3.994 SPLIT ACREAGE

013

740.41' N 89°12'W

DOUGLAS R. + DEBRA A. DONAHDE
DEED V. 1175, P. 364

SURVEY OF SPLIT FOR CARL RAZZANTE
O.L. 29 GRAFTON TWP.

JOHN R. HAMILTON
REG. SURVEYOR #6861

JUNE, 1984

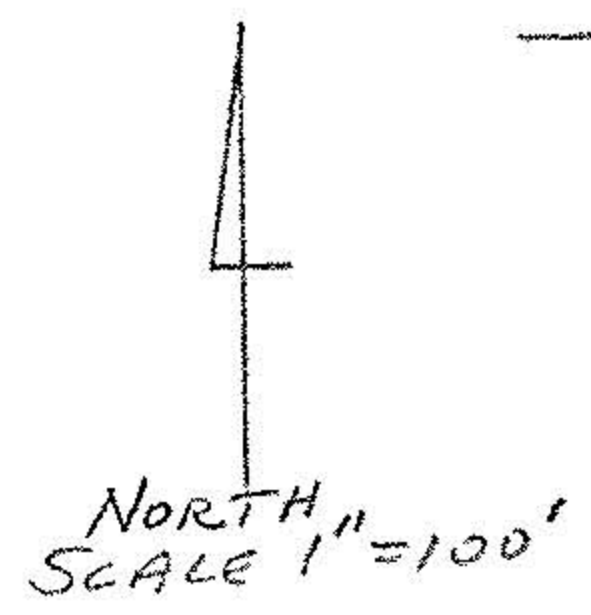

997.87' N 51°15' W

IP SET

IP SET

235.00 N 1°15' E

235.00'

IP SET

IP SET

O.L. 29

IP SET