

198 ES

5.0187 ACRES

5.0212 ACRES

ABT. 0.976 Ac. OL 24
ABT. 4.042 Ac. OL 21

16-00-027-000

93.971 ACRES

510- OL 24
510- OL 21

800-

600-

ABT. 62.93 Ac., OL 21

Pt. - 010

#9473

16-00-027-000

#9473

16-00-027-000

010-

ABT. 62.93 Ac., OL 21

SEP 10 1976



Survey By

JR Four Assoc

16-C

ISLAND

ROAD 60'

ISLAND

ROAD

60'

9473
#9473
16C

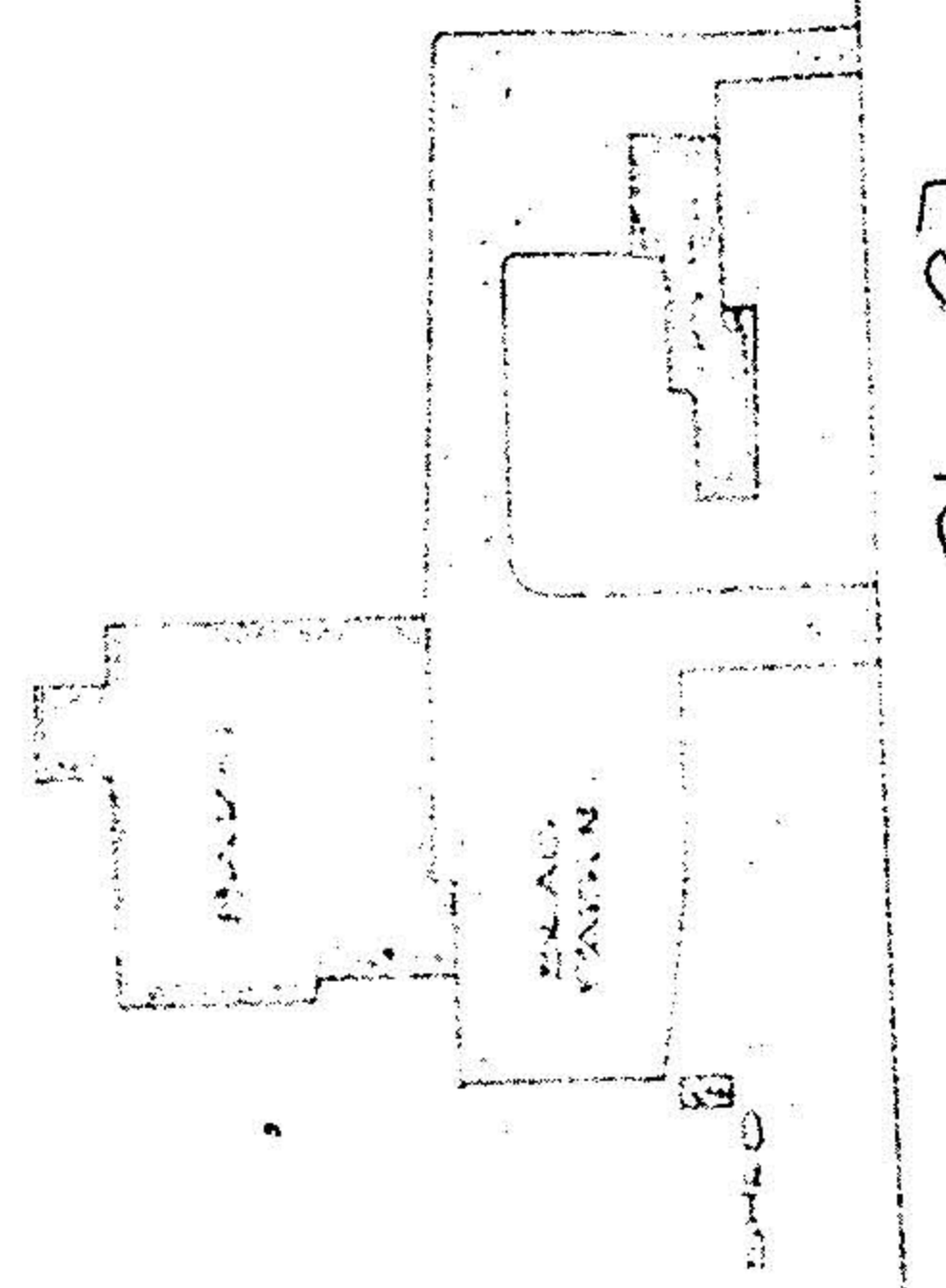

16-00-027-000
16-00-027-000
16-00-027-000

16-00-027-000