

AS SIMON & ASSOCIATES, INC.  
PROFESSIONAL LAND SURVEYORS

8901 CLEMENS RD. #119  
WESTLAKE, OH. 44145  
PH. (216) 871-1391  
FAX 871-7335

SURVEY FOR: DR. LAWRENCE PALL

ORIG. LOT 99	CITY OF	DATE 9/14/96 SCALE: 1"=100'
ORIG. SEC.	VILLAGE OF	DWN. BY TAS
TRACT	COUNTY OF LORAIN	JOB NO. 96-030
TOWNSHIP OF GRAFTON	STATE OF OHIO	

21936

DIMENSIONS SHOWN ON THIS PLAT ARE EXPRESSED IN FEET AND DECIMAL PARTS THEREOF. ALL BEARINGS ARE TO AN ASSUMED MERIDIAN AND ARE USED TO DESCRIBE ANGLES ONLY. PERMANENT MONUMENTS WERE FOUND OR SET AS INDICATED, ALL OF WHICH I CERTIFY TO BE CORRECT.

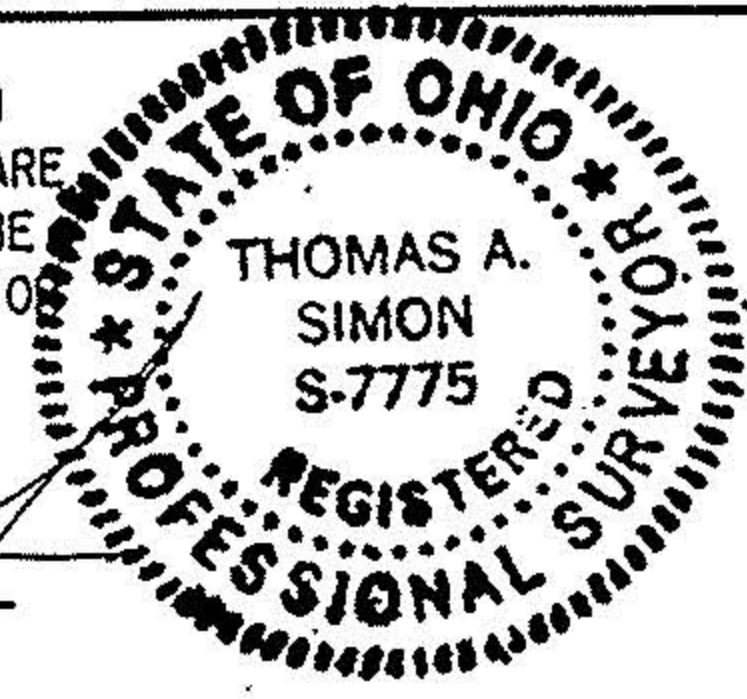

APPROVED  
LORAIN CO.  
MAP DEPT.  
DATE 10-4-96  
PAGE 16-E  
BY K. DYE  
VOID AFTER # 21936

THOMAS A. SIMON  
REG. PROFESSIONAL  
SURVEYOR NO. S-7775

565.00' R.  
565.02' M.  
R.R. SPK. PD. & USED  
RR SPK. PD. & USED  
RE SPL. PD. & USED @  
N.W. CORNER O.L. 99

16-00-099-000-008  
LAWRENCE PALL  
O.K. VOL. 74 P. 683

16-00-099-000-004  
LAWRENCE PALL  
O.R. VOL. 74 P. 683

