

Neal Raymond ETAL  
 Div 1148 Pg 410  
 Div 1011 Pg 569

- o Iron pins fd
- o Iron pins set
- x RRS set

20 wide easements  
 No 1 20' x 500'  
 No 2 20' x 200'

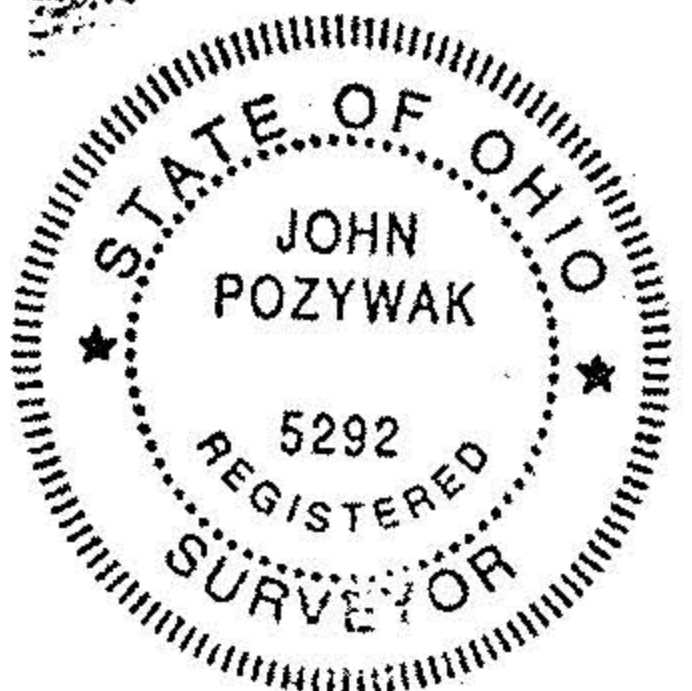

#22302

APPROVED LORAIN CO. MAP DEPT
DATE 10/14/97
PAGE 16-H
BY K. Colbert
#22302

Survey of Parcel Splits  
 Original Lot 89  
 Grafton Township  
 Lorain County Ohio  
 Scale 1" = 200' June 1997  
 John Pozywak Reg Surveyor  
 5292