

I.P. fd in Map. Box  
I.P. fd in Map. Box

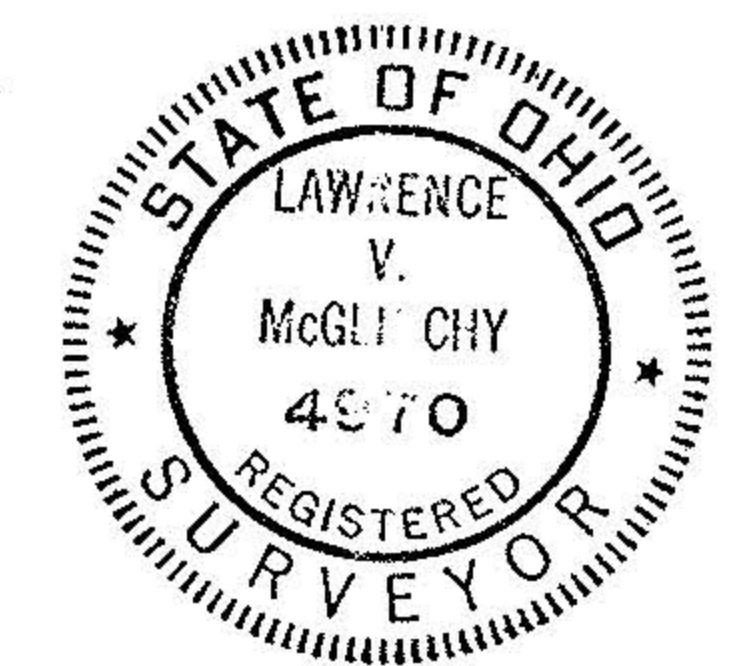

SCALE: 1"=50'

LEGEND  
O = I.P. SET



MAP of PROPOSED PARCEL SPLIT  
PREPARED FOR JOHN E. KARL  
PART of ORIGINAL GRAFTON TOWNSHIP LOT 80  
TOWNSHIP of GRAFTON, LORAIN COUNTY, OHIO  
 REF: PP# 16-00-080-000-016

**#15939**  
 APPROVED  
 LORAIN CO.  
 MAP DEPT.  
 DATE 12-13-84  
 PAGE 16-E  
 BY T. McMan  
 VOID  
 AFTER

McGLINCHY and ASSOCIATES INC.  
PROFESSIONAL ENGINEER & SURVEYORS  
110 1/2 MIDDLE AVE. ELYRIA, OHIO  
AUGUST, 1983  
# 837945